



Molded Case Circuit Breaker Specifications

Bulletin 140G, 140MG

Topic	Page
Introduction to Circuit Breakers	3
Circuit Breaker Basics	3
Anatomy of Bulletin 140G Circuit Breakers	6
Internal Accessories	11
External Accessories	11
Properties of a Circuit Breaker	15
Circuit Protections and Device Self-Protections	19
Circuit Breaker Applications	21
Applying Molded Case Circuit Breakers to North American Guidelines	22
Selecting a Circuit Breaker When Application Follows U.S. Guidelines	23
Specialty Operating Conditions	26
Product Overview	29
Device Types and Accessories	29
Product Selection—Molded Case Circuit Breakers	31
125 A, G-Frame Molded Case Circuit Breakers	32
125 A, H-Frame Molded Case Circuit Breakers	34
225 A I-Frame Case Circuit Breakers	40
250 A, J-Frame Molded Case Circuit Breakers	42
400 A, K-Frame Molded Case Circuit Breakers	48
800 A, M-Frame Molded Case Circuit Breakers	54
1200 A, N-Frame Molded Case Circuit Breakers	59
1200 A, NS-Frame Molded Case Circuit Breakers	63
2000...3000 A, R-Frame Molded Case Circuit Breakers	66
Product Selection—Motor Circuit Protectors	68
Catalog Number Explanation	69
Motor Ratings	71
Product Selection—Motor Protection Circuit Breakers	74
Catalog Number Explanation	75
Product Selection—Molded Case Switches	76
Catalog Number Explanation	76
Factory-installed Modifications	78
Accessories	79
Internal Accessories	79
External Accessories	83
Terminal Accessories	93
Replacement Parts	96

Topic	Page
Specifications	101
Bulletin 140G Molded Case Circuit Breakers	101
Bulletin 140G Molded Case Switches	106
Bulletin 140G Current-limiting Molded Case Circuit Breakers	108
Bulletin 140MG Motor Circuit Protectors	110
Bulletin 140MG Motor Protection Circuit Breakers	113
Temperature Derating for All Bulletin 140G/MG Devices	114
Watt Loss for All Bulletin 140G/MG Devices	120
Accessory Specifications	123
Electrical Diagrams	131
Status Contacts	131
Protection/Control Accessories	134
Operators	138
Trip and Let-through Curves	140
Using Trip and Let-through Curves	140
Trip and Let-through Curve Index	142
Bulletin 140G Thermal-magnetic MCCB Trip Curves	144
Bulletin 140G Electronic MCCB Trip Curves	170
Bulletin 140G Current-limiting MCCB Total Let-through Curves	190
Bulletin 140MG Motor Circuit Protectors Trip Curves	194
Bulletin 140MG Motor Protection Circuit Breakers Trip Curves	202
Approximate Dimensions	204
Bulletin 140G/MG G-Frame	204
Bulletin 140G/MG H-Frame	215
Bulletin 140G/MG I-Frame	227
Bulletin 140G/MG J-Frame	239
Bulletin 140G/MG K-Frame	250
Bulletin 140G/MG M-Frame	258
Bulletin 140G/MG N-Frame	265
Bulletin 140G NS-Frame	274
Bulletin 140G R-Frame	279
Bulletin 1494V Variable Depth, Flange-operated Circuit Breaker Operating Mechanisms	283
Additional Resources	285

Catalog Number Explanation

Examples that are given in this section are not intended to be used for product selection. Not all combinations generate a valid catalog number. Use ProposalWorks™ software to configure the MPCB. ProposalWorks software is available from rok.auto/systemtools.



Terminal lugs are not supplied and can be ordered separately. See [page 93](#) for available lugs.



140MG - J 8 E - D15 - SD - AA
 a b c d e f f

a	
Bulletin Number	
Code	Description
140MG	Motor Protection Circuit Breaker

b	
Frame/Rating	
Code	Description
H	100 A
J	150 A

c	
Interrupting Rating/Breaking Capacity (based on I_c at 480V)	
Code	Description
8	High break

d	
Protection Type	
Code	Description
E	LUI

e	
Rated Current	
Code	Description
C	example: C25 = 25 A
D	example: D15 = 150 A

f
Factory-installed Internal Options—see page 78

Table 115 - Interrupting Rating/Breaking Capacity

Interrupting Rating (50/60 Hz), UL 489/CSA C22.2, No. 5 [kA]			Breaking Capacity (50/60 Hz), IEC 60947-2							
240V	480V	600V	220V ⁽¹⁾		415V		440V ⁽¹⁾		690V	
			I_{cu} [kA]	I_{cs} [% I_{cu}]	I_{cu} [kA]	I_{cs} [% I_{cu}]	I_{cu} [kA]	I_{cs} [% I_{cu}]	I_{cu} [kA]	I_{cs} [% I_{cu}]
150	65	25	100	100	70	100	65	100	15	100

(1) These ratings have not been tested for the CCC listing.

Table 116 - Motor Protection Circuit Breaker—H- and J-Frame Devices

Max. Rated Motor Current I_n [A]	L (Motor FLC)		U	I	Cat. No. ⁽¹⁾
	$I_1 = 0.4...1 \times I_n$	Trip Class	50% of I_1	$I_n = \text{Instantaneous}$	
H-Frame					
25	10...25	3E, 5E, 10E, 20E (approx. 2...20 s)	ON or OFF	Adjustable from 6...13 x I_n	140MG-H8E-C25
60	24...60				140MG-H8E-C60
100	40...100				140MG-H8E-D10
J-Frame					
40	16...40	3E, 5E, 10E, 20E (approx. 2...20 s)	ON or OFF	Adjustable from 6...13 x I_n	140MG-J8E-C40
60	24...60				140MG-J8E-C60
100	40...100				140MG-J8E-D10
150	60...150				140MG-J8E-D15

(1) Select the Motor Protection Circuit Breaker based on the motor FLC.

Bulletin 140MG Motor Protection Circuit Breakers

Table 202 - Performance Characteristics

Attribute		H-Frame	J-Frame	
Max. Rated Current	[A]	100	150	
Rated insulation voltage, U_i , IEC	[V]	1000	1000	
Rated impulse withstand voltage, U_{imp}	[kV]	8	8	
NEMA, UL, CSA Ratings				
Interrupting Rating Code⁽¹⁾		H8	J8	
240V AC, 50/60 Hz	[kA]	150	150	
480V AC, 50/60 Hz	[kA]	65	65	
600V AC, 50/60 Hz	[kA]	25	25	
IEC 60947-2 Ratings				
Rated ultimate short-circuit breaking capacity, I_{cu}	220...230V AC, 50/60 Hz	[kA]	100	100
	380V AC, 50/60 Hz	[kA]	70	70
	400...415V AC, 50/60 Hz	[kA]	70	70
	440V AC, 50/60 Hz	[kA]	65	65
	525V AC, 50/60 Hz	[kA]	15	45
	550V AC, 50/60 Hz	[kA]	15	45
	690V AC, 50/60 Hz	[kA]	15	15
	250V DC- 2 poles in series	[kA]	70	70
	500V DC- 3 poles in series	[kA]	70	70
Rated service short-circuit breaking capacity, I_{cs}	220...230V AC, 50/60 Hz	% I_{cu}	100%	100%
	380V AC, 50/60 Hz	% I_{cu}	100%	100%
	400...415V AC, 50/60 Hz	% I_{cu}	100%	100%
	440V AC, 50/60 Hz	% I_{cu}	100%	100%
	525V AC, 50/60 Hz	% I_{cu}	100%	100%
	550V AC, 50/60 Hz	% I_{cu}	100%	100%
	690V AC, 50/60 Hz	% I_{cu}	100%	100%
	250V DC- 2 poles in series	% I_{cu}	100%	100%
	500V DC- 3 poles in series	% I_{cu}	100%	100%

(1) Explanation of Interrupting Code. Example: code H8, H=H-Frame; 8= 65 kA@480V. See product selection for complete ratings

Table 203 - Mechanical and Environmental Ratings

Attribute		H-Frame	J-Frame
Mechanical Life	[No. of Operations]	25000	25000
	[Operations/hour]	240	240
Electrical Life @ 415V (AC)	[No. of Operations]	8000	8000
	[Operations/hour]	120	120
Wire Temperature Rating ⁽¹⁾		Cu; 75 °C (167 °F)	Al or Cu; 75 °C (167 °F)
Ambient Temperature without derating		40 °C (104 °F)	40 °C (104 °F)
Operational Temperature		-25...+70 °C (-13...+158 °F)	-25...+70 °C (-13...+158 °F)
Storage Temperature		-40...+70 °C (-40...158 °F)	-40...+70 °C (-40...158 °F)
Dimensions [Width/Depth/Height]	[mm (in.)]	90 x 82.5 x 130 (3.54 x 3.25 x 5.12)	105 x 82.5 x 160 (4.13 x 3.25 x 6.3)
Weight (approx.)	[lb. (kg)]	2.6 (1.2)	5.5 (2.5)

(1) Wire temperature rating is determined by testing the circuit breaker under full load current with the conductors sized for 75 °C (167 °F).

Bulletin 140G/MG J-Frame

Dimensions are in millimeters (inches). Dimensions are not intended to be used for manufacturing purposes.

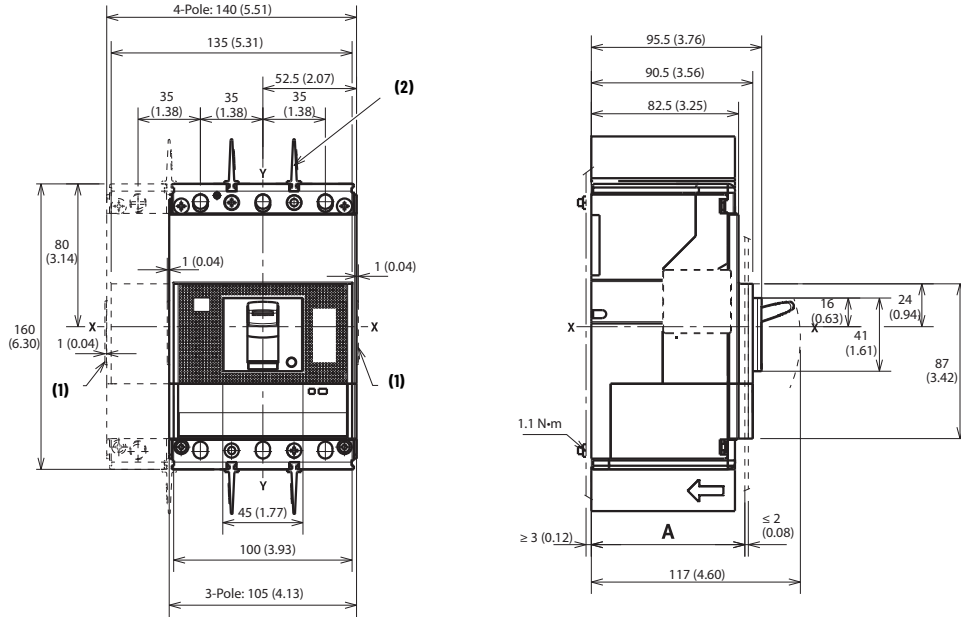
 Dimension tolerances ± 0.1 mm (0.004 in)

Figure 176 - Panel Mounted Molded Case Circuit Breaker



Description	No. of Poles	A
With escutcheon	3...4	86 (3.39)
Without escutcheon	3...4	83.5 (3.29)
	3...4	91.5 (3.60)

Note	Information
1	Overall dimensions of optional wiring ducts
2	Required 25 mm (0.98 in.) insulating phase barriers are provided