



TNT 32

Test monitoring unit



Dimensioned drawing

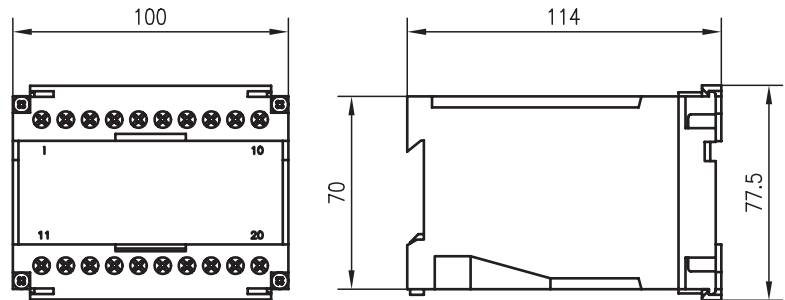

- Connection possibility for all throughbeam protective photoelectric sensors (AOPD category 2) with test or activation input
- Starting test with 2 channel test input
- 2 channel output with forced security relay contacts
- Integrated start and restart-disable

Electrical connection

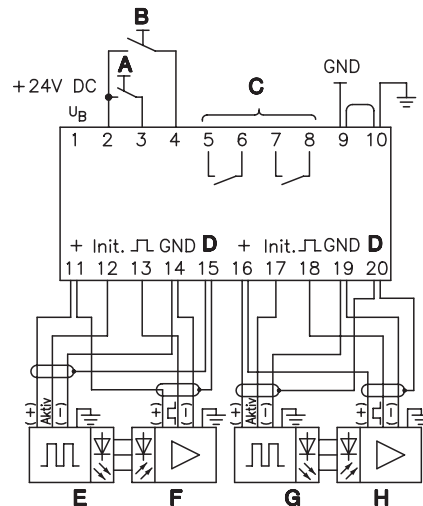
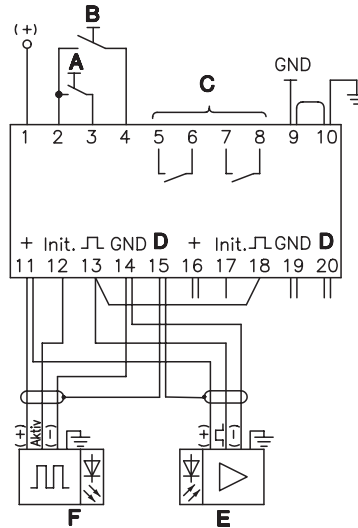

- A Test 1
- B Test 2
- C Outputs
- D Shield
- E Re 1
- F Tr 1
- G Re 2
- H Tr 2



Accessories:

(available separately)

- EC model tested throughbeam protective photoelectric sensors of the series:
 - 46 Series
 - 78 Series
 - 85 Series
 - 92 Series
 - 95 Series
 - 96 Series
 - 763 Series

We reserve the right to make changes • SLS_s01e.fm

Specifications

Electrical data

Supply

Operating voltage U_B	24VDC
Residual ripple	$\leq 15\%$ of U_B
Current consumption	approx. 200mA
Response time	≤ 20 ms

Test inputs

Voltage	$+U_B$ (active high)
Current	≤ 25 mA
Pulse duration	≥ 60 ms

Outputs

2 voltage free relay contacts (make-contact)		
Switching voltage	220 VAC	10 ... 60VDC
Switching current	2.0A	2A (resistive load)
Fuse	2A MT	

Mechanical data

Dimensions	100x77.5x114mm (WxHxD)
Weight	approx. 470g
Housing	polycarbonate, cover ABS/v-o grey
Connection	screw connections 2x2.5mm ² acc. to DIN 46288
Mounting type	snap-on mounting for standard rail

Environmental data

Ambient temp. (operation/storage)	-20°C ... +60°C/-30°C ... +70°C
Protection class	IP 40 (only for application in electrical operating rooms/ switching cabinet with minimum protection class IP 54 is suitable)

Tables

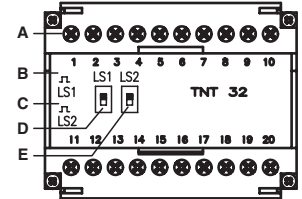

- A Connection terminals
- B Status display light barrier 1
- C Status display light barrier 2
- D Selector switch activation level light barrier LS1
- E Selector switch activation level light barrier LS2

Diagrams

Order guide

Designation	Part No.
TNT 32	500 20476

Remarks

- The test monitoring unit TNT 32 is an electro sensitive protective device (ESPE) category 2 according to prEN 50100-1, only in connection with an EC certified protective photoelectric sensor (AOPD category 2).