

FAG

6038-M

Deep groove ball bearing

Deep groove ball bearing 60...-M, single row, solid brass cage

Technical information

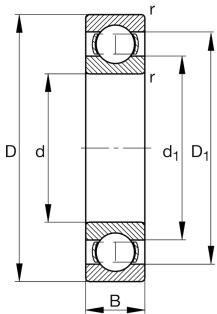

Your current product variant

| | | |
|----------------------------------|--------------|--|
| Sealing | Without | Not sealed |
| Cage | M | Solid brass cage, rolling element guided |
| Tolerance class | PN | Normal (PN) |
| Dimensional / heat stabilization | S1 | Rings dimensional stabilized up to 200° |
| Lubricant | Without | Bearing not greased |
| Radial internal clearance | CN (Group N) | Normal internal clearance |
| Bore type | Z | Cylindrical |

Main Dimensions & Performance Data

| | | |
|-----------------|-------------|-----------------------------------|
| d | 190 mm | Bore diameter |
| D | 290 mm | Outside diameter |
| B | 46 mm | Width |
| C _r | 216,000 N | Basic dynamic load rating, radial |
| C _{0r} | 220,000 N | Basic static load rating, radial |
| C _{ur} | 9,400 N | Fatigue load limit, radial |
| n _G | 3,850 1/min | Limiting speed |
| n _{gr} | 3,100 1/min | Reference speed |
| ≈m | 11.3 kg | Weight |



Mounting dimensions

| | | |
|--------------------|----------|--------------------------------------|
| d _{a min} | 200.2 mm | Minimum diameter shaft shoulder |
| D _{a max} | 279.8 mm | Maximum diameter of housing shoulder |
| r _{a max} | 2.1 mm | Maximum fillet radius |

Dimensions

| | | |
|------------------|-----------|------------------------------|
| r _{min} | 2.1 mm | Minimum chamfer dimension |
| D ₁ | 260.25 mm | Shoulder diameter outer ring |
| d ₁ | 220.82 mm | Shoulder diameter inner ring |







Temperature range

| | | |
|------------------|--------|----------------------------|
| T _{min} | -30 °C | Operating temperature min. |
| T _{max} | 200 °C | Operating temperature max. |

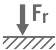
Calculation factors

| | | |
|----------------|------|--------------------|
| f ₀ | 15.6 | Calculation factor |
|----------------|------|--------------------|

Characteristics

| | |
|---|------------------------------|
|  | Radial load |
|  | Axial load in one direction |
|  | Axial load in two directions |
|  | Grease Lubrication |
|  | Oil Lubrication |
|  | Not sealed |