

**Standard & Special
Indicator lights
DEFENCE**



Creating control and signalling solutions for harsh environments.



Visit MAFELEC at our website: www.mafelec.com



MAFELEC is a specialist in the design of control and signalling components intended to operate in the cold, heat, projections of liquids, dust, shock, vibration, ...



THE QUALITY APPROACH

In a context where markets are ever more competitive, MAFELEC stands out for its voluntarist quality approach, aimed at customer satisfaction.

Very active involvement at all levels in the Company has enabled MAFELEC to obtain certification to :

ISO 9001 V2000
OTIS Q+ (Otis lifts)
AQAP 110 (Defence)
RQPF (Paris Underground/Subway)
ISO 14001

Other know-how recognizance :
ALSTOM TRANSPORT for LP150 Programme

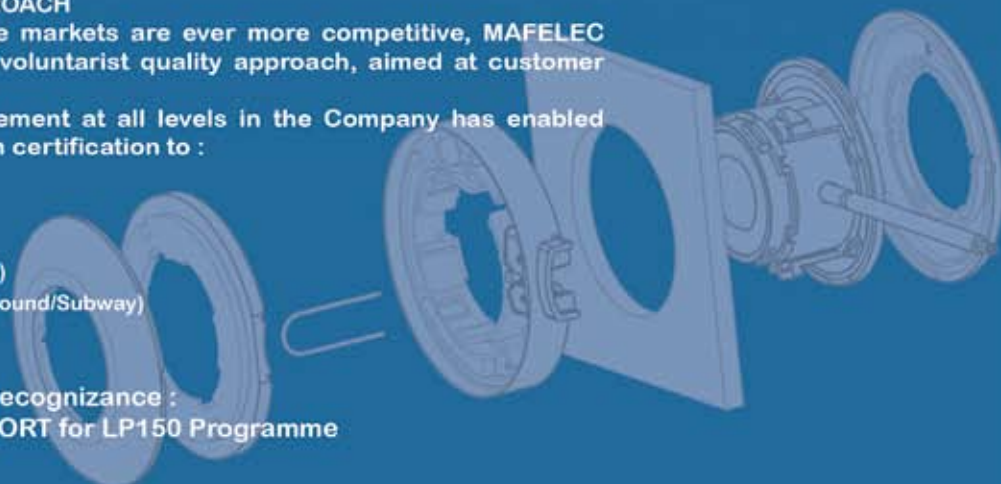

Standard & Special Indicator lights

Contents

Standard lights	1
General characteristics - standard lights	3
Environmental characteristics	
Electrical characteristics	
Standard round indicator lights (cutout Ø : 8 to 16 mm)	
Complete units	
Indicator lights Ø : 8 mm - 1 LED	4
Indicator lights Ø : 12 mm - 1 LED	6
Indicator lights Ø : 16 mm - 4 LEDs - front-replaceable	8
Standard round indicator lights (cutout Ø : 22.5 mm)	
Complete units	
Indicator lights Ø : 22 mm - 4 LEDs - front-replaceable	9
Indicator lights Ø : 22 mm - 4 LEDs	10
Indicator lights Ø : 22 mm - 7 LEDs - dimmer protective cover	11
Indicator lights Ø : 22 mm - 14 LEDs	12
Indicator lights Ø : 22 mm - 1 Ba9S lamp	12
Indicator lights Ø : 22 mm - 2 Midget lamps	13
Standard square indicator lights (cutout Ø : 22.5 mm)	
Complete units	
Indicator lights Ø : 22 mm - 14 SMD LEDs	14
Indicator lights Ø : 22 mm - two-tone 2 x 8 SMD LED	14
Indicator lights Ø : 22 mm - with lamps	15
Round indicator lights (cutout Ø : 30.5 mm)	
Complete units	
Indicator lights Ø : 30 mm - SMD LEDs	16
Indicator lights Ø : 30 mm - Ba9S lamps	16
Subassemblies	
Modular elements for customisation	
Round heads for Ø 22 mm indicator lights	17
Re-legendable heads for Ø 22 mm indicator lights	17
Square heads for Ø 22 mm indicator lights	18
Standard heads for Ø 30 mm indicator lights	18
Re-legendable heads for Ø 30 mm indicator lights	18
Electrical subassemblies for round heads indicator lights	19
Electrical subassemblies for square and re-legendable heads indicator lights	20
Electrical subassemblies for Ø 30 mm indicator lights	21
Accessories for Ø 22 and 30 mm indicator lights	
LED lamp, gasket ...	22-23
Special indicator lights	24
Complete units	
LED lights, O.D. 36 mm.	25
LED lights, O.D. 40 mm; cutout Ø : 36 mm.	25
LED lights, O.D. 45 mm; cutout Ø : 39 mm.	26
LED lights, O.D. 57 mm; cutout Ø : 50 mm.	26
LED lights, O.D. 82 mm; cutout Ø : 56 mm.	27
Lamp indicator lights, O.D. 82 mm; cutout Ø : 36 / 40 mm.	28
External signalling units.	29
Flat LED lights.	30
Beacon-style lights : 3-way visibility.	31
LED Tail lights	31

Standard indicator lights

Adaptability
Modularity
Safety
Reliability



④



⑤



①



②



③



⑥



The range of possibilities :

- ① **Functional and ergonomic indicator lights**
 - Versions for Ø8, Ø16, Ø22 or Ø30 mm cutouts.
 - Flush, projecting or ultra-projecting bezels.
 - Round or square.
 - With flat, convex, conical, recessed, ... covers.
 - Wide range of colours.
- ② **"A la carte" brightness**
 - The brightness of the MAFELEC indicator lights can be adapted to their environment by selecting the model and the specific technology: single or multiple LEDs, SMD LED, water-droplet type LED, LEDs on BA9S socket, lamp.
- ③ **Evolutive markings**
 - Re-legendable heads
 - Cover and lamp (BA9S versions) can be replaced from the front, without removing the indicator light.
- ④ **Choice of connections**
 - Screws and brackets or washers, IP2 protection
 - Single or double tabs for 6.35 mm lugs straight, 90°, 45° (contact us for the other connection types).
 - Tapping for earthing.
- ⑤ **Watertight and robust**
 - Watertight IP67 versions.
 - High mechanical resistance.
 - Tropicalisation.
- ⑥ **Rugged mode of attachment**
 - Moulded metal body.
(for most of the indicator lights in the Ø 22 and Ø 30 range)
 - Attachment by punch screws (self-locking, anti-rotation) guaranteeing excellent resistance to shock and vibration.

The modular design of MAFELEC's control and signalling components provides for a multitude of combinations and adaptations..

The examples illustrated in this catalogue only represent a fraction of the designs produced by our Design Office every day for our customers.

All alternative solutions can be designed from the basic elements, to produce the desired function.



Our equipment complies with the European RoHS directive, restricting the use of certain dangerous substances in electrical equipment.

Standard indicator lights



Environmental characteristics

Compliance with standards	IEC et NF EN 60947-5-1 (depending on the model)
Protective finish	Tropicalisation (operation + 40°C with 95% humidity)
Resistance to vibration	Per IEC and NF EN 61373, IEC and NF EN 60068-2-6
Ambient air temperature	Storage : - 40°C to + 85°C Operation : - 25°C to + 70°C IEC and NF EN 60068-2-1, IEC and NF EN 60068-2-2
Protection against surges	Depending on the model - Class 1 (Connection by tabs) or class 2 (screws, clamp plates IP2x) per IEC and NF EN 61140
Fire resistance	Per NF F 16 102 (depending on the model)
Protection level	Per IEC and NF EN 60529 - Ø 8 with truncated protective cover : IP65, IP66, IP67 & IP69K - Ø 8 with chrome plated-bezel : IP65 - Ø 12 with truncated protective cover : IP65, IP66, IP67 & IP69K - Ø 12 with chrome plated-bezel : IP40 - Ø 16 : IP 40 - Ø 22 : no gasket = IP 40 - with JE gasket = IP 54 - with JE gasket + capped head = IP66 to IP67
Protection against accidental contact with the active circuit	IP2X per IEC and NF EN 60529 (depending on the model)

Electrical characteristics (depending on the model)

	LED lights	Lamp indicator lights
Power supply voltage	6V to 400V AC / DC	6V to 400V AC / DC
Current consumption	From 10 mA to 40 mA	Depending on the lamps
Polarity marking	Depending on the model	
Operating range	0.8 Un U 1.1 Un	
Electrical surges	Withstands 2.5 times the rated voltage for 10 µs	

Standard indicator lights



Lights with protected LED - Cutout Ø : 8 mm

- 1 LED, Ø 3 mm - Power supply : AC/DC - ballast resistor and reverse polarity protection diode
- Connection by 2.8 x 0.5 mm tabs and solder
- Attachment from the rear by H nut or plastic nut + two locking screws

Description	Voltage	Colour	Part number	Weight kg
Light, ø 8 mm with truncated segment protective cover Overmolded product - Degree of protection* IP65, IP66, IP67 and IP69K	6V	red	VLP08 B D 22 C A F5	0.003
		orange	VLP08 B D 23 C A F5	
		yellow	VLP08 B D 24 C A F5	
		green	VLP08 B D 25 C A F5	
		dark blue	VLP08 B D 26 C A F5	
		crystal	VLP08 B D 28 C A F5	
		white	VLP08 B D 29 C A F5	
	12V	red	VLP08 B D 32 C A F5	
		orange	VLP08 B D 33 C A F5	
		yellow	VLP08 B D 34 C A F5	
		green	VLP08 B D 35 C A F5	
		dark blue	VLP08 B D 36 C A F5	
		crystal	VLP08 B D 38 C A F5	
		white	VLP08 B D 39 C A F5	
	24V	red	VLP08 B D 42 C A F5	
		orange	VLP08 B D 43 C A F5	
		yellow	VLP08 B D 44 C A F5	
		green	VLP08 B D 45 C A F5	
		dark blue	VLP08 B D 46 C A F5	
		crystal	VLP08 B D 48 C A F5	
		white	VLP08 B D 49 C A F5	
36/48V	red	VLP08 B D 52 C A F5		
	orange	VLP08 B D 53 C A F5		
	yellow	VLP08 B D 54 C A F5		
	green	VLP08 B D 55 C A F5		
	dark blue	VLP08 B D 56 C A F5		
	crystal	VLP08 B D 58 C A F5		
	white	VLP08 B D 59 C A F5		
72V	red	VLP08 B D 62 C A F5		
	orange	VLP08 B D 63 C A F5		
	yellow	VLP08 B D 64 C A F5		
	green	VLP08 B D 65 C A F5		
	dark blue	VLP08 B D 66 C A F5		
	crystal	VLP08 B D 68 C A F5		
	white	VLP08 B D 69 C A F5		



Other luminosity : **Hight luminosity**
 Replace B by **H**
 Example : VLP08 **H** D 59 C B F5

*IP on the front part when mounting recommendations are respecting (plat and smooth surface, mounting torque at 0.5 Nm)

Standard indicator lights



Lights with LED visible - Cutout Ø : 8 mm

- 1 LED, Ø 3 mm - Power supply : AC/DC - ballast resistor and reverse polarity protection diode
- Connection by 2.8 x 0.5 mm tabs and solder
- Attachment from the rear by H nut or plastic nut + two locking screws

Description	Voltage	Colour	Part number	Weight kg
Light, ø 8 mm with chrome-plated bezel Overmolded product - Degree of protection* IP65	6V	red	VLP08 B D 22 S A F5	0.003
		amber	VLP08 B D 23 S A F5	
		yellow	VLP08 B D 24 S A F5	
		green	VLP08 B D 25 S A F5	
		dark blue	VLP08 B D 26 S A F5	
		white	VLP08 B D 29 S A F5	
	12V	red	VLP08 B D 32 S A F5	
		amber	VLP08 B D 33 S A F5	
		yellow	VLP08 B D 34 S A F5	
		green	VLP08 B D 35 S A F5	
		dark blue	VLP08 B D 36 S A F5	
		white	VLP08 B D 39 S A F5	
	24V	red	VLP08 B D 42 S A F5	
		amber	VLP08 B D 43 S A F5	
		yellow	VLP08 B D 44 S A F5	
		green	VLP08 B D 45 S A F5	
		dark blue	VLP08 B D 46 S A F5	
		white	VLP08 B D 49 S A F5	
	36/48V	red	VLP08 B D 52 S A F5	
amber		VLP08 B D 53 S A F5		
yellow		VLP08 B D 54 S A F5		
green		VLP08 B D 55 S A F5		
dark blue		VLP08 B D 56 S A F5		
white		VLP08 B D 59 S A F5		
72V	red	VLP08 B D 62 S A F5		
	amber	VLP08 B D 63 S A F5		
	yellow	VLP08 B D 64 S A F5		
	green	VLP08 B D 65 S A F5		
	dark blue	VLP08 B D 66 S A F5		
	white	VLP08 B D 69 S A F5		



* IP on the front part when mounting recommendations are respecting (flat and smooth surface, mounting torque at 0.5 Nm)

Other luminosity : Hight luminosity

Replace B by **H**

Example : VLP08 **H** D 59 C B F5

Dimensions

Panel cutouts

Support thickness : 1 to 6 mm

Lights with protected LED

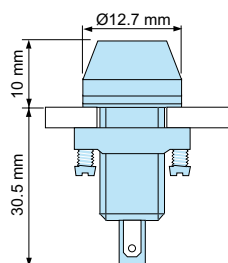

Lights with LED visible

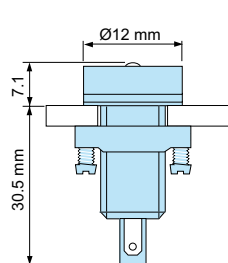

Standard distances between centres

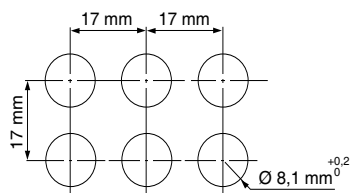

Reduced distance between centres

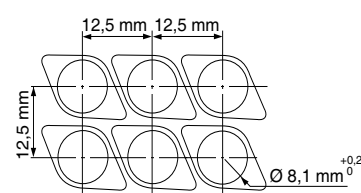

Standard indicator lights



Lights with protected LED - Cutout Ø : 12 mm

- 1 LED, Ø5 mm - Power supply : AC/DC - ballast resistor and reverse polarity protection diode
- Connection by 2.8 x 0.5 mm tabs and solder
- Attachment from the rear by H nut or plastic nut + two locking screws

Description	Voltage	Colour	Part number	Weight kg
Light, ø 12 mm with truncated segment protective cover Overmolded product - Degree of protection* IP65, IP66, IP67 and IP69K	6V	red	VLP12 B D 22 C A F5	0.003
		orange	VLP12 B D 23 C A F5	
		yellow	VLP12 B D 24 C A F5	
		green	VLP12 B D 25 C A F5	
		dark blue	VLP12 B D 26 C A F5	
		crystal	VLP12 B D 28 C A F5	
	white	VLP12 B D 29 C A F5		
	12V	red	VLP12 B D 32 C A F5	
		orange	VLP12 B D 33 C A F5	
		yellow	VLP12 B D 34 C A F5	
		green	VLP12 B D 35 C A F5	
		dark blue	VLP12 B D 36 C A F5	
		crystal	VLP12 B D 38 C A F5	
	white	VLP12 B D 39 C A F5		
	24V	red	VLP12 B D 42 C A F5	
		orange	VLP12 B D 43 C A F5	
		yellow	VLP12 B D 44 C A F5	
		green	VLP12 B D 45 C A F5	
		dark blue	VLP12 B D 46 C A F5	
		crystal	VLP12 B D 48 C A F5	
	white	VLP12 B D 49 C A F5		
	36/48V	red	VLP12 B D 52 C A F5	
		orange	VLP12 B D 53 C A F5	
		yellow	VLP12 B D 54 C A F5	
		green	VLP12 B D 55 C A F5	
		dark blue	VLP12 B D 56 C A F5	
		crystal	VLP12 B D 58 C A F5	
	white	VLP12 B D 59 C A F5		
	72V	red	VLP12 B D 62 C A F5	
orange		VLP12 B D 63 C A F5		
yellow		VLP12 B D 64 C A F5		
green		VLP12 B D 65 C A F5		
dark blue		VLP12 B D 66 C A F5		
crystal		VLP12 B D 68 C A F5		
white	VLP12 B D 69 C A F5			



Polaroid heads/Black out function/ (manual light setting) contact us.

* IP on the front part when mounting recommendations are respecting (plat and smooth surface, mounting torque at 0.5 Nm)

Other luminosity : Hight luminosity

Replace B by H

Example : VLP12 H D 59 C B F5

Standard indicator lights



Lights with LED visible - Cutout Ø : 12 mm

- 1 LED, Ø5 mm - Power supply : AC/DC - ballast resistor and reverse polarity protection diode
- Connection by 2.8 x 0.5 mm tabs and solder
- Attachment from the rear by H nut or plastic nut + two locking screws

Description	Voltage	Colour	Part number	Weight kg
Light, ø 12 mm with chrome-plated bezel	6V	red	VLP12 B D 22 S A F5	0.003
		amber	VLP12 B D 23 S A F5	
Overmolded product		yellow	VLP12 B D 24 S A F5	
		green	VLP12 B D 25 S A F5	
		dark blue	VLP12 B D 26 S A F5	
		white	VLP12 B D 29 S A F5	
		12V	red	VLP12 B D 32 S A F5
		amber	VLP12 B D 33 S A F5	
		yellow	VLP12 B D 34 S A F5	
		green	VLP12 B D 35 S A F5	
		dark blue	VLP12 B D 36 S A F5	
		white	VLP12 B D 39 S A F5	
24V		red	VLP12 B D 42 S A F5	
		amber	VLP12 B D 43 S A F5	
		yellow	VLP12 B D 44 S A F5	
		green	VLP12 B D 45 S A F5	
		dark blue	VLP12 B D 46 S A F5	
36/48V		white	VLP12 B D 49 S A F5	
		red	VLP12 B D 52 S A F5	
		amber	VLP12 B D 53 S A F5	
		yellow	VLP12 B D 54 S A F5	
		green	VLP12 B D 55 S A F5	
72V		dark blue	VLP12 B D 56 S A F5	
		white	VLP12 B D 59 S A F5	
		red	VLP12 B D 62 S A F5	
		amber	VLP12 B D 63 S A F5	
		yellow	VLP12 B D 64 S A F5	
		green	VLP12 B D 65 S A F5	
		dark blue	VLP12 B D 66 S A F5	
		white	VLP12 B D 69 S A F5	



Polaroid heads/Black out function/
(manual light setting)
contact us.

* IP on the front part when mounting
recommendations are respecting (plat
and smooth surface, mounting torque at
0.5 Nm)

IP40

Other luminosity : Hight luminosity

Replace B by **H**

Example : VLP12 **H** D 59 S B F5

Dimensions

Support thickness : 1 to 6 mm

Light with
protected LED

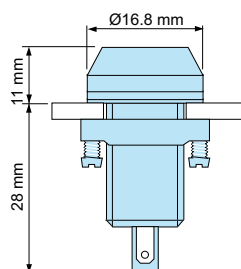

Light with
LED visible

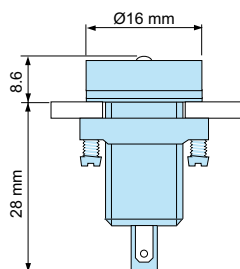

Panel cutouts

Standard distances
between centres

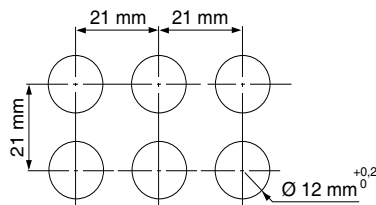

Reduced distance
between centres

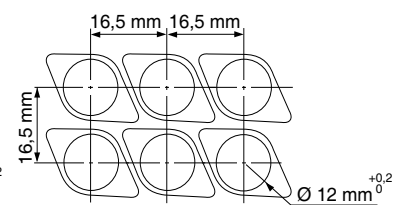

Standard indicator lights



LED lights - Cutout Ø : 16 mm

- 4 LEDs Ø 3 mm - Active circuit can be removed from the front (no polarity : rectifier bridge)
- Black metal bezel - Grey plastic body
- Connection : Double tabs for 6.35 mm clip.
- Protection against accidental contact with the active circuit - Degree of protection : IP40

Description	Colour	Part number	Weight kg
LED light, ø 16 mm with removable active circuit	green	YSJ392A2V ..	0.040
	red	YSJ392A2R ..	
	yellow	YSJ392A2J ..	
	orange	YSJ392A2A ..	
	blanc	YSJ392A2O ..	
	Other connection :		
1 = Double tab version for 5 mm clip Example : YSJ 392 A 1 O 125			
Voltage : Complete the P/N			
		6	AC / DC 6V
		12	AC / DC 12V
		24	AC / DC 24V
		48	AC / DC 48V
		125	AC / DC 130V

Voltage : Complete the P/N

VOLTAGE CODE



Subassemblies

- Subassembly comprising : 4 LEDs, 1 resistor, 1 rectifier bridge on PCB with soldered protective cover.

Description	Colour	Part number	Weight kg
Active circuit for YSJ 392.	green	YSJ448V ..	0.005
	red	YSJ448R ..	
	yellow	YSJ448J ..	
	orange	YSJ448A ..	
	blanc	YSJ448O ..	
Voltage : Complete the P/N			
		6V	AC / DC 6
		12V	AC / DC 12
		24V	AC / DC 24
		48V	AC / DC 48
		130V	AC / DC 125

Voltage : Complete the P/N

VOLTAGE CODE



Dimensions

Support thickness : 1 to 6 mm

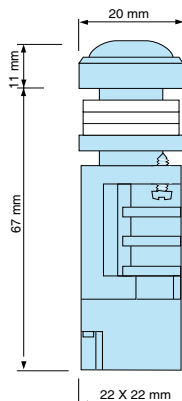

Panel cutouts

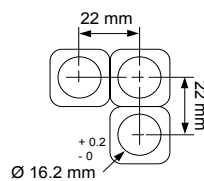

In-line layout
Voltage < 48 V

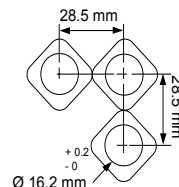

Diagonal layout
Voltage > 48 V

Power supply schematic

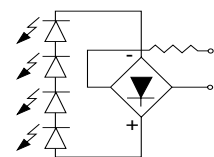

Wiring : no polarity,
comply with operating
voltage

Standard indicator lights



LED lights - Cutout Ø : 22 mm

- 4 LEDs, Ø 5 mm - Active circuit can be removed from the front (no polarity : rectifier bridge).
 - Black metal bezel- Polycarbonate convex protective cover - Degree of protection : IP40 or IP55 with "TJ" gasket - Connection : Double tabs for 6.35 mm clip.

Description	Voltage	Colour	Part number	Weight kg
Led light, ø 22 mm with active circuit front-replaceable	12V AC / DC	●	YSK357 C1 V .. TJ	0.135
		●	YSK357 C1 R .. TJ	
		●	YSK357 C1 J .. TJ	
		●	YSK357 C1 A .. TJ	
		○	YSK357 C1 O .. TJ	



Other Colours: Contact us.
 (Blue colour possible)

Other attachment :

D = Compact version - Example : YSK 357 **D** 2 O 220
 Tightened by nut at the front and compensation washers depending on the thickness of the front panel. (available on request)

Other connection :

2 = Double tabs for 5 mm clip - Example : YSK 357 **C** 2 O 220

Voltage : Complete the P/N

12	12V AC / DC
24	24V AC / DC
48	48V AC / DC
125	130 AC / DC
220	230 AC / DC

VOLTAGE CODE



Subassemblies

Subassembly comprising LEDs, resistor and rectifier bridge on PCB with soldered protective cover

Description	Colour	Part number	Weight kg
	●	YSK421V ..	0.07
	●	YSK421R ..	
	●	YSK421J ..	
	●	YSK421A ..	
	○	YSK421O ..	



Voltage : Complete the P/N

12	12V AC / DC
24	24V AC / DC
48	48V AC / DC
125	130 AC / DC
220	230 AC / DC

VOLTAGE CODE

Dimensions

Panel cutouts

YSK357C.

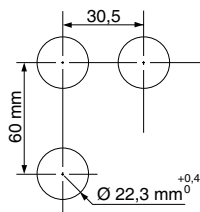
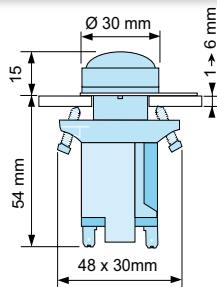

YSK357D.

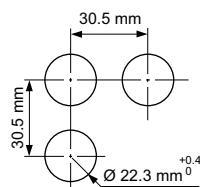
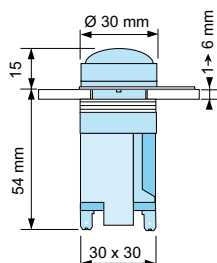

Standard indicator lights



LED lights - Cutout Ø : 22 mm

- 4 LEDs, Ø 5 mm - No polarity - Convex protective cover - Black metal bezel - Attachment by punch screws
- Degree of protection IP40 or IP55 with "TJ" gasket - Connection : screws, clamp plate IP2x

Description	Power supply	Voltage	Colour	Part number	Weight kg	
Direct	AC / DC	12V	●	K22LAR5B23 V 25 TJ	0.070	
		24V	AC / DC	●		K22LAR2B23 V 25 TJ
			●	K22LAR4B23 V 25 TJ		
			●	K22LAR3B23 V 25 TJ		
			●	K22LAR6B23 V 25 TJ		
			○	K22LAR9B23 V 25 TJ		
	48V	AC / DC	24V	●		K22LAR5B24 V 25 TJ
			●	K22LAR2B24 V 25 TJ		
			●	K22LAR4B24 V 25 TJ		
			●	K22LAR3B24 V 25 TJ		
			●	K22LAR6B24 V 25 TJ		
	○	K22LAR9B24 V 25 TJ				
	72V	AC / DC	48V	●		K22LAR5B25 V 25 TJ
			●	K22LAR2B25 V 25 TJ		
			●	K22LAR4B25 V 25 TJ		
			●	K22LAR3B25 V 25 TJ		
			●	K22LAR6B25 V 25 TJ		
	○	K22LAR9B25 V 25 TJ				
130V	AC / DC	72V	●	K22LAR5B26 V 25 TJ		
		●	K22LAR2B26 V 25 TJ			
		●	K22LAR4B26 V 25 TJ			
		●	K22LAR3B26 V 25 TJ			
		●	K22LAR6B26 V 25 TJ			
○	K22LAR9B26 V 25 TJ					
Other connection :	Transformer 230 / 6V	130V	●	K22LAR5B27 V 25 TJ		
		●	K22LAR2B27 V 25 TJ			
		●	K22LAR4B27 V 25 TJ			
		●	K22LAR3B27 V 25 TJ			
		●	K22LAR6B27 V 25 TJ			
○	K22LAR9B27 V 25 TJ					



F = Double tabs for 6.35 mm clip
Example : **K22 LA R9 B27 F 25**

Connection: screw/ clamp plate IP2x	Transformer 230 / 6V	230V	●	YSK409C1V220 TJ	0.140	
		AC	●	YSK409C1R220 TJ		
			●	YSK409C1J220 TJ		
			●	YSK409C1A220 TJ		
			●	YSK409C1B220 TJ		
	○	YSK409C1O220 TJ				
	Transformer 400 / 6V	AC	400V	●		YSK409C1V380 TJ
			●	YSK409C1R380 TJ		
			●	YSK409C1J380 TJ		
			●	YSK409C1A380 TJ		
●			YSK409C1B380 TJ			
○	YSK409C1O380 TJ					



Dimensions

Panel cutouts

K22 L . B2

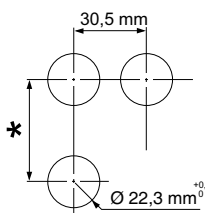
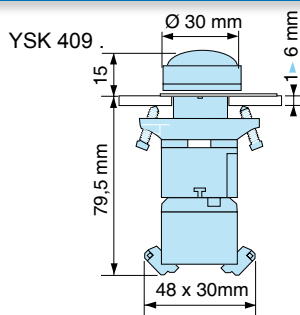
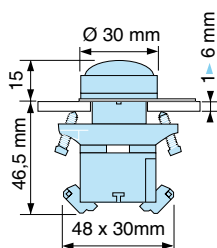

* Connection
by screws = 60 mm
by tabs = 90 mm

Standard indicator lights



LED lights - Cutout Ø : 22 mm

- 7 LEDs, Ø 5 mm - Black metal bezel, watertight polaroid protective cover - Attachment by punch screws
- Degree of protection IP40, IP55 with "TJ" gasket - Connection : Double tabs for 6.35 mm clip.

Description	Voltage	Colour	Part number	Weight kg
Light, ø 22 mm with dimmer cover	24V DC	●	K22LPR5C04 V 25 TJ	0.120
		●	K22LPR2C04 V 25 TJ	
		●	K22LPR4C04 V 25 TJ	
		●	K22LPR3C04 V 25 TJ	
		●	K22LPR6C04 V 25 TJ	
	48V DC	○	K22LPR9C04 V 25 TJ	
		●	K22LPR5C05 V 25 TJ	
		●	K22LPR2C05 V 25 TJ	
		●	K22LPR4C05 V 25 TJ	
		●	K22LPR3C05 V 25 TJ	
	72V DC	●	K22LPR6C05 V 25 TJ	
		○	K22LPR9C05 V 25 TJ	
		●	K22LPR5C06 V 25 TJ	
		●	K22LPR2C06 V 25 TJ	
		●	K22LPR4C06 V 25 TJ	
		●	K22LPR3C06 V 25 TJ	
		●	K22LPR6C06 V 25 TJ	
		○	K22LPR9C06 V 25 TJ	



Other connection :

F = Double tabs for 6.35 mm clip

Example : K22LPR9C06 **F** 25 TJ

LA = Flush protective cover

Example : K22 LA R5 C04 V25

- 14 LEDs, Ø 5 mm - Black metal bezel - Attachment by punch screws
- Degree of protection IP40, IP55 with "TJ" gasket - Connection : Double tabs for 6.35 mm clip.

Description	Voltage	Colour	Part number	Weight kg
Light, ø 22 mm very high luminosity	24V DC	●	K22LAR5G04 V 25 TJ	0.130
		●	K22LAR2G04 V 25 TJ	
		●	K22LAR4G04 V 25 TJ	
		●	K22LAR3G04 V 25 TJ	
	48V DC	●	K22LAR5G05 V 25 TJ	
		●	K22LAR2G05 V 25 TJ	
		●	K22LAR4G05 V 25 TJ	
		●	K22LAR3G05 V 25 TJ	
	72V DC	●	K22LAR5G06 V 25 TJ	
			K22LAR2G06 V 25 TJ	
			K22LAR4G06 V 25 TJ	
			K22LAR3G06 V 25 TJ	



Other connection :

F = Double tabs for 6.35 mm clip

Example : K22 LA R3 G 06 **F** 25 TJ

Dimensions

Panel cutouts

K22 LP.

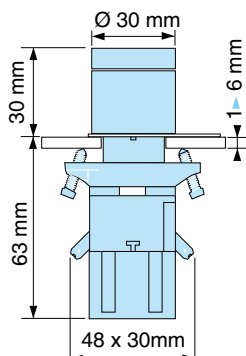

K22 LA.

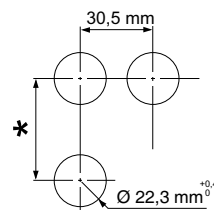
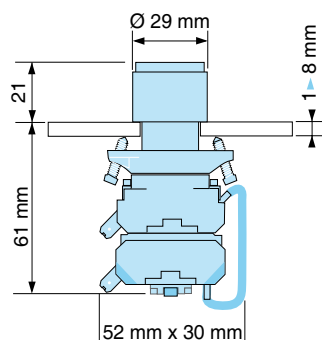

* Connection by screws = 60 mm
by tabs = 90 mm

Standard indicator lights



Lights with Ba9S lamps - Cutout Ø : 22 mm

- Ba9S Lamp - 10 x 28 - Max. 3 W - Chrome-plated metal bezel - Polycarbonate protective cover
- Attachment by punch screws - Degree of protection IP40, IP55 with "TJ" gasket - IP67 version possible on request
- Connection : screws, clamp plate IP2x (except for lights with resistors).

Description	Power supply	Voltage	Colour	Part number	Weight kg	
lamp indicator light	Direct	6 to 400V AC/DC (depending on lamp selected)	●	L22VAVBA9S	TJ	0.071
	Lamp not supplied		●	L22VARBA9S	TJ	
			●	L22VAJBA9S	TJ	
Resistor	230 / 130V 130V-30mA lamp	230V AC/DC	●	L22VAVBA9SRE1	TJ	0.076
			●	L22VARBA9SRE1	TJ	
			●	L22VAJBA9SRE1	TJ	
Resistor	230 / 48V-30mA 48V-30mA lamp	230V AC/DC	●	L22VAVBA9SRE2	TJ	
			●	L22VARBA9SRE2	TJ	
			●	L22VAJBA9SRE2	TJ	
Resistor	130 / 48V-30mA 48V-30mA lamp	130V AC/DC	●	L22VAVBA9SRE3	TJ	
			●	L22VARBA9SRE3	TJ	
			●	L22VAJBA9SRE3	TJ	



Other connection :

F2 = Double tabs for 6.35 mm clip
Example : L22VAJBA9SRE3 **F2** TJ

Lamp indicator light	130 / 6V	130V/50 Hz	●	L22VAVBA9ST1	TJ	0.133
	Transformer 6V-1W lamp	110 -120V/60Hz	●	L22VARBA9ST1	TJ	
		AC	●	L22VAJBA9ST1	TJ	
Transformer 6V-1W lamp	230 / 6V	230V/50 Hz AC	●	L22VAVBA9ST2	TJ	
			●	L22VARBA9ST2	TJ	
			●	L22VAJBA9ST2	TJ	
Transformer 6V-1W lamp	400 / 6V	400V/50 Hz AC	●	L22VAVBA9ST3	TJ	
			●	L22VARBA9ST3	TJ	
			●	L22VAJBA9ST3	TJ	
Transformer 24V-1W lamp	130 / 24V	130V/50 Hz 110 -120V/60 Hz AC	●	L22VAVBA9ST4	TJ	
			●	L22VARBA9ST4	TJ	
			●	L22VAJBA9ST4	TJ	
Transformer 24V-1W lamp	230 / 24V	230V/50 Hz AC	●	L22VAVBA9ST5	TJ	
			●	L22VARBA9ST5	TJ	
			●	L22VAJBA9ST5	TJ	



Dimensions

Panel cutouts

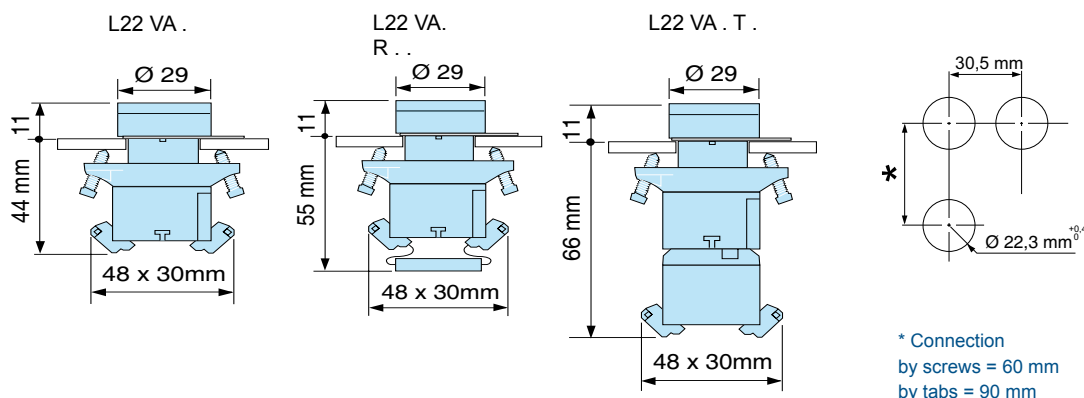

Standard indicator lights



Lights with Ba9S lamps - Cutout Ø : 22 mm (O.D. 41 mm)

- Ba9S lamp - 10 x 28 - 3 W max. - Black metal bezel - Polycarbonate convex protective cover - Attachment by punch screws.
- Degree of protection IP40, IP55 with "TJ" gasket - Connection : screw / clamp plate IP2X

Description	Power supply	Voltage	Colour	Part number	Weight kg
Lamp indicator light Large protective cover	Direct	6 to 400V	●	L22VGAVBa9S	TJ 0.090
	Lamp not supplied	AC/ DC (depending on lamp selected)	●	L22VGARBa9S	TJ
			●	L22VGAJBa9S	TJ
			●	L22VGABBa9S	TJ
			○	L22VGAOBa9S	TJ
			⊗	L22VGAIBa9S	TJ



Other connection :

F2 = Double tabs for 6.35 mm clip

Example : **L22 VGAI Ba9S F2 TJ**

Indicator lights with midget lamps - Cutout Ø : 22 mm (fault signalling)

- Two 60V midget lamps - 10 000 hr - Black metal bezel - Polycarbonate convex protective cover - Attachment by punch screws
- Degree of protection IP40, IP55 with "TJ" gasket - Connection : Double tabs for 6.35 mm clip
- Continues to signal even if one of the two lamps fails.
- Connected to two separate signalling circuits.

Description	Power supply	Voltage	Colour	Part number	Weight kg
Lamp indicator light with dual circuit	Direct	48V AC/ DC	●	YSK359A1V48	TJ 0.095
			●	YSK359A1R48	TJ
			●	YSK359A1J48	TJ
			○	YSK359A1O48	TJ
			●	YSK359A1V125	TJ
	130V AC/ DC	●	YSK359A1R125	TJ	
		●	YSK359A1J125	TJ	
		○	YSK369A1O125	TJ	



Dimensions

Panel cutouts

Support thickness 1 to 6 mm

L22 VGA.

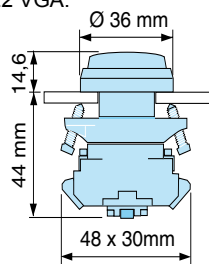

YSK 359.

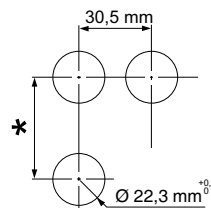
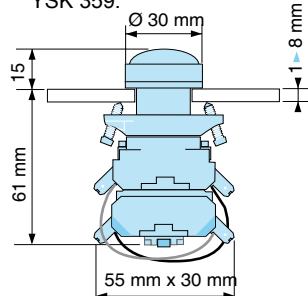

* Connection
by screws = 60 mm
by tabs = 90 mm

Standard indicator lights



Square LED lights - Cutout Ø : 22 mm

- 14 SMD LEDs - Black plastic bezel - Attachment by punch screws - Degree of protection IP40.
- Connection : Double tabs for 6.35 mm clip

Description	Voltage	Colour	Part number	Weight kg
LED lighth with monochrome square protective cover Contact us for markings on the cover or other colours	24V DC		K22KAR5G04 F 23 TJ	0.110
			K22KAR2G04 F 23 TJ	
			K22KAR4G04 F 23 TJ	
			K22KAR3G04 F 23 TJ	
	48V DC		K22KAR5G05 F 23 TJ	
			K22KAR2G05 F 23 TJ	
			K22KAR4G05 F 23 TJ	
			K22KAR3G05 F 23 TJ	
	72V DC		K22KAR5G06 F 23 TJ	
			K22KAR2G06 F 23 TJ	
			K22KAR4G06 F 23 TJ	
			K22KAR3G06 F 23 TJ	



- 2 x 8 SMD LED - Black plastic bezel - Attachment by punch screws - Degree of protection IP40.
- Connection : Double tabs for 6.35 mm clip

Description	Voltage	Colours	Part number	Weight kg
LED lighth with two-tone square protective cover Double circuit Contact us for markings on the cover or other colours	24V DC		K22KA45H04 F 23 TJ	0.110
			K22KA54H04 F 23 TJ	
			K22KA42H04 F 23 TJ	
			K22KA24H04 F 23 TJ	
			K22KA43H04 F 23 TJ	
			K22KA34H04 F 23 TJ	
			K22KA52H04 F 23 TJ	
			K22KA25H04 F 23 TJ	
			K22KA53H04 F 23 TJ	
			K22KA35H04 F 23 TJ	
	48V DC		K22KA45H05 F 23 TJ	
			K22KA54H05 F 23 TJ	
			K22KA42H05 F 23 TJ	
			K22KA24H05 F 23 TJ	
			K22KA43H05 F 23 TJ	
			K22KA34H05 F 23 TJ	
			K22KA52H05 F 23 TJ	
			K22KA25H05 F 23 TJ	
			K22KA53H05 F 23 TJ	
			K22KA35H05 F 23 TJ	
72V DC		K22KA45H06 F 23 TJ		
		K22KA54H06 F 23 TJ		
		K22KA42H06 F 23 TJ		
		K22KA24H06 F 23 TJ		
		K22KA43H06 F 23 TJ		
		K22KA34H06 F 23 TJ		
		K22KA52H06 F 23 TJ		
		K22KA25H06 F 23 TJ		
		K22KA53H06 F 23 TJ		
		K22KA35H06 F 23 TJ		



Other connection :

= screw / clamp plate IP2x

Example : K22 KA 32H 06 25 TJ

Dimensions

Panel cutouts

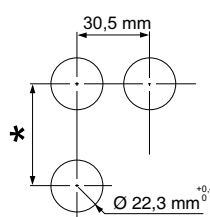
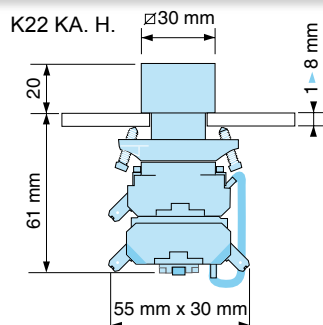
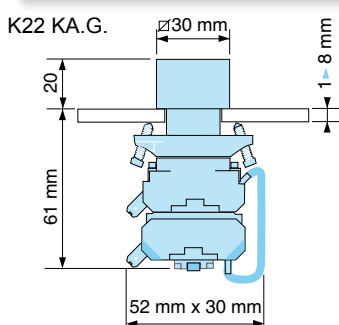

* Connection by screws = 60 mm
by tabs = 90 mm

Standard indicator lights



Lights with Ba9S lamps - Cutout Ø : 22 mm

- Ba9S lamp -10 x 28 - 3 W max. - Connection : screw / clamp plate - IP2X (except for lights with resistors)

Description	Power supply	Voltage	Colour	Part number	Weight kg
Lamp indicator light with square protective cover Contact us for markings on the cover or other colours.	Direct Lamp not supplied	6 to 400V AC/ DC (depending on lamp selected)	Green	L22KQAV BA9S TJ	0.086
			Red	L22KQAR BA9S TJ	
			Yellow	L22KQAJ BA9S TJ	
	230 / 130V Resistor 130V-30mA lamp	230V AC / DC	Green	L22KQAVRE1 TJ	
			Red	L22KQARRE1 TJ	
			Yellow	L22KQAJRE1 TJ	
	230 / 48V-30mA Resistor 48V-30mA lamp	230V AC / DC	Green	L22KQAVRE2 TJ	
			Red	L22KQARRE2 TJ	
			Yellow	L22KQAJRE2 TJ	
	130 / 48V-30mA Resistor 48V-30mA lamp	130V AC / DC	Green	L22KQAVRE3 TJ	
			Red	L22KQARRE3 TJ	
			Yellow	L22KQAJRE3 TJ	

Other connection :

F2 = Double tabs for 6.35 mm clip

Example : L22 KQAJ RE3 **F2** TJ



Lamp indicator light with square protective cover Contact us for markings on the cover or other colours.	130 / 6V Transformer 6V-1W lamp	130V/50 Hz 110 -120V/60 Hz AC	Green	L22KQAVT1 TJ	0.144
			Red	L22KQART1 TJ	
			Yellow	L22KQAJT1 TJ	
	230 / 6V Transformer 6V-1W lamp		Green	L22KQAVT2 TJ	
			Red	L22KQART2 TJ	
			Yellow	L22KQAJT2 TJ	
	400 / 6V Transformer 6V-1W lamp		Green	L22KQAVT3 TJ	
			Red	L22KQART3 TJ	
			Yellow	L22KQAJT3 TJ	
	130 / 24V Transformer 24V-1W lamp		Green	L22KQAVT4 TJ	
			Red	L22KQART4 TJ	
			Yellow	L22KQAJT4 TJ	
230 / 24V Transformer 24V-1W lamp		Green	L22KQAVT5 TJ		
		Red	L22KQART5 TJ		
		Yellow	L22KQAJT5 TJ		



Some examples :

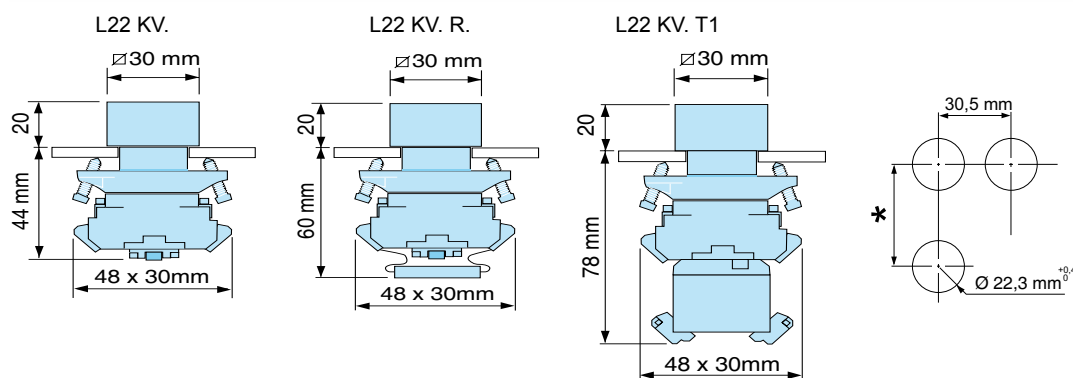

* Connection
by screws = 60 mm
by tabs = 90 mm

Standard indicator lights



LED lights - Cutout Ø : 30 mm

- Metal bezel - Polycarbonate protective cover - SMD LEDs - No polarity - Attachment by punch screws
- Connection : screw / clamp plate IP2x - Degree of protection: IP 40

Description	Colour	Part number	Weight kg
Flush light with multiple LEDs	red	LADR2 .. V2 2F TJ	0.134
	orange	LADR3 .. V2 2F TJ	
	yellow	LADR4 .. V2 2F TJ	
	green	LADR5 .. V2 2F TJ	
	blue	LADR6 .. V2 2F TJ	
	white	LADR9 .. V2 2F TJ	
Voltage : Complete the P/N		24V AC / DC 24	Other connection : F2 = Double tabs for 6.35 mm clip Example : LADR924 F2 2F TJ
(with tapping for earthing)		48V AC / DC 25	
		72V AC / DC 26	
		110V AC / DC 27	
		VOLTAGE CODE	



Re-legendable Ba9S LED lights - Cutout Ø : 30 mm

- Metal bezel - Plastic protective cover - LED mounted on Ba9S socket - No polarity - Lamp and pictogram can be replaced from the front (special tool)
- Attachment by punch screws - Connection : Double tabs for 6.35 mm clip - IP54

Description	Colour	Part number		Weight kg
		Chrome bezel	Black bezel	
Flush light marking on head can be changed	red	L1LR2SRRF2J TJ	L5LR2SRRF2J TJ	0.134
	orange	L1LR3SRRF2J TJ	L5LR2SRRF2J TJ	
	yellow	L1LR4SRRF2J TJ	L5LR2SRRF2J TJ	
	green	L1LR5SRRF2J TJ	L5LR2SRRF2J TJ	
	blue	L1LR6SRRF2J TJ	L5LR2SRRF2J TJ	
	white	L1LR9SRRF2J TJ	L5LR2SRRF2J TJ	
	transparent	L1LR1SRRF2J TJ	L5LR2SRRF2J TJ	
Black or chrome bezel				
Blank label ①				
Text and pictogram on request				
Multiple degree of protection possible: IP40 to IP65				
Other connection : V = screw / clamp plate IP2X Example : L1LR2SRR V2 J TJ				

New !

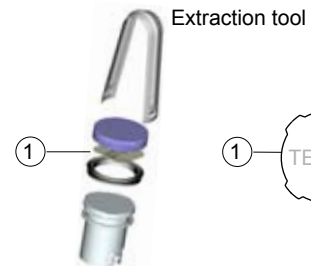

Other version : Flush light, marking on square head (Ø 37 mm, cutout Ø 30 mm^{+0.2}), contact us.



Dimensions

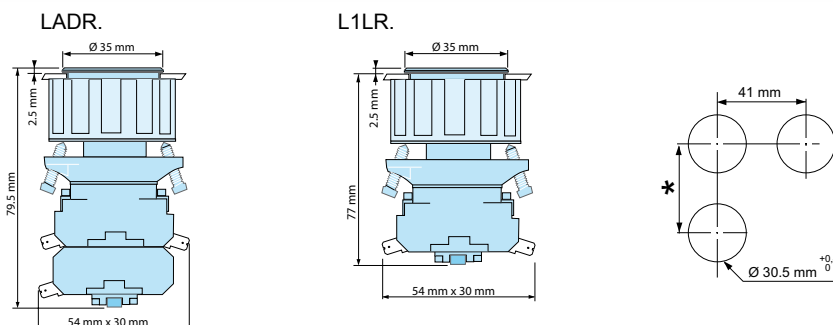

* Connection
by screws = 60 mm
by tabs = 90 mm

Standard indicator lights



Subassemblies - Round heads for indicator lights - Ø 22 mm Range

- Metal bezel - Polycarbonate protective cover

Description	Type	Colour	Part number		Weight kg			
			Chrome bezel	Black bezel				
Round heads for indicator lights with Ba9S lamps	Flush Fits on body : L22V.	●	L22CAV		0.016			
		●	L22CAR					
		●	L22CAJ					
		●	L22CAB					
		○	L22CAO					
		⊗	L22CAI					
	Convex, high temperature (115°) Fits on body : L22VHT.	●		YSK1084B5	0.016			
		●		YSK1084B2				
		●		YSK1084B4				
		●		YSK1084B6				
○		YSK1084B9						
	⊗	YSK1084B8						
IP66 Add TJ gasket	Flush, with cap Fits on body : YSK 1030.	●	L22TCELV		0.032			
		●	L22TCELR					
		●	L22TCELJ					
		●	L22TCELB					
		○	L22TCELO					
			⊗			L22TCELI		
		Round heads for LED lights	Convex Fits on body : K22 LA. YSK 409			●		YSK 1202 A5
●	YSK 1202 A2							
●	YSK 1202 A4							
●	YSK 1202 A3							
●	YSK 1202 A6							
○	YSK 1202 A9							
	⊗			YSK 1202 A8				
Round Polaroid heads with dimmer cover	truncated segment Fits on body : L22V. K22 L.			●	L22CPV			
		●	L22CPR					
		●	L22CPJ					
		●	L22CPB					
		○	L22CPO					
			⊗					



Subassemblies - Re-legendable heads for round lights - Ø 22 mm Range

- Metal bezel - Polycarbonate protective cover - **Pictogram can be replaced from the front** (special tool)
- To fit on L22KV electrical subassemblies

Description	Colour	Part number		Weight kg		
		Chrome bezel	Black bezel			
Round, flush heads, marking on head can be changed	●	K1LR2S	K5LR2S	0.010		
	●	K1LR3S	K5LR3S			
	●	K1LR4S	K5LR4S			
	●	K1LR5S	K5LR5S			
	●	K1LR6S	K5LR6S			
	○	K1LR9S	K5LR9S			
	○	K1LR1S	K5LR1S			
	⊗					
	Blank label					
	Text and pictogram on request					

New !



Dimensions

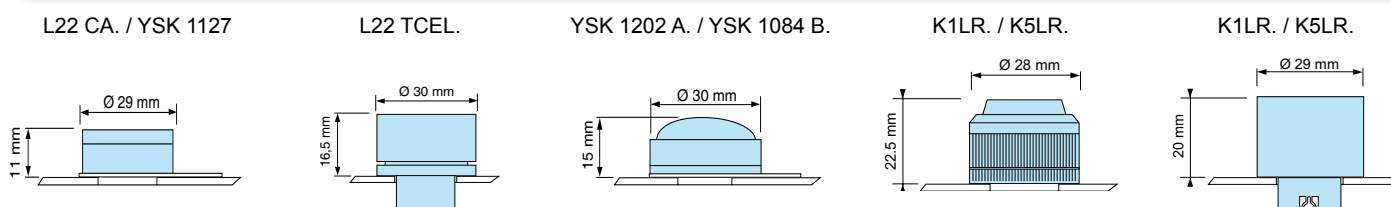

Standard indicator lights



Subassemblies - Heads for square indicator lights - Ø 22 mm Range

- Plastic bezel and protective cover

Description	Type	Colour	Part number	Weight kg
Square heads for indicator lights with Ba9S lamps	Flush		L22KCAV	0.011
			L22KCAR	
			L22KCAJ	
			L22KCAB	
			L22KCAO	
	Projecting		L22KCDV	0.016
			L22KCDR	
			L22KCDJ	
			L22KCDB	
			L22KCDO	
Fits on body : L22KV.			L22KCAI	

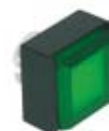
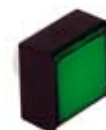

Subassemblies - Round heads for indicator lights - Ø 30 mm Range

- Metal bezel - Plastic protective cover - (Possibility of engraving the cover, contact us)
- To fit on LRDR electrical subassemblies.

Description	Colour	Part number		Weight kg	
		Chrome bezel	Black bezel		
Round, flush heads with integrated LEDs Ring MAL924B1 + washer EDU750A1 must be added when mounting control components from the 30 mm range (see accessories chapter)		LAR2 . 1	LAR2 . 2	0.022	
		LAR3 . 1	LAR3 . 2		
		LAR4 . 1	LAR4 . 2		
		LAR5 . 1	LAR5 . 2		
		LAR6 . 1	LAR6 . 2		
		LAR9 . 1	LAR9 . 2		
	Voltage : Complete the P/N (With tapping for earthing)	24V	AC / DC 4		4
		48V	AC / DC 5		5
		72V	AC / DC 6		6
		110V	AC / DC 7		7
		▲ VOLTAGE CODE ▲			



Subassemblies - Re-legendable heads for round lights - Ø 30 mm Range

- Metal bezel - Polycarbonate protective cover - **Pictogram can be replaced from the front** (special tool)
- To fit on L22KV electrical subassemblies

Description	Colour	Part number		Weight kg	
		Chrome bezel	Black bezel		
Round, flush heads, marking on head can be changed Ring MAL924B1 + washer EDU750A1 must be added when mounting control components from the 30 mm range (see accessories chapter)		L1LR2S	L5LR2S	0.010	
		L1LR3S	L5LR3S		
		L1LR4S	L5LR4S		
		L1LR5S	L5LR5S		
		L1LR6S	L5LR6S		
		L1LR9S	L5LR9S		
	Multiple degree of protection possible: IP40 to IP65		L1LR1S		L5LR1S

Blank label
Text and pictogram on request



Dimensions

L22 KCA.

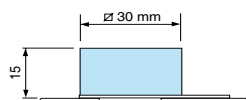

L22 KCD.

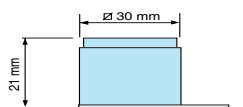

LAR. / L1LR. / L5LR.

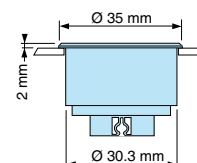

Standard indicator lights



Subassemblies - Bodies for indicator lights with BA9S lamps (round heads)

- Lamp not supplied (except for versions with resistor or transformer) - Pwr = max. 3W
- Attachment by punch screws - Connection: screw / clamp plate IP2x (except for resistor versions)

Description	Power supply	Voltage	Part number	Weight kg
Light body with removable lamp-holder	Direct Lamp not supplied	6 to 400V AC/DC (depending on lamp selected)	L22 V Ba9S TJ	0.055
			L22 V HT Ba9S TJ	
	Resistor		L22 V Ba9S RE TJ	0.057
			L22 V Ba9S RE1 TJ	0.060
			L22 V Ba9S RE2 TJ	
L22 V Ba9S RE3 TJ				
Other connection :				
F2 = Double tabs for 6.35 mm clip				
Example : L22 V Ba9S RE3 F2 TJ				
Light body with integrated lamp-holder for screw-on protective cover	Direct Lamp not supplied	6 to 400V AC/DC (depending on lamp selected)	YSK 1030 TJ	0.075
			L22 V Ba9S T1 TJ	
			L22 V Ba9S T2 TJ	
			L22 V Ba9S T3 TJ	
			L22 V Ba9S T4 TJ	
			L22 V Ba9S T5 TJ	
Other connection :				
F2 = Double tabs for 6.35 mm clip				
Example : YSK 1030 F2 TJ				
Light body with integrated lamp-holder for screw-on protective cover	Direct Lamp not supplied	6 to 400V AC/DC (depending on lamp selected)	YSK 1030 T1 TJ	0.133
			YSK 1030 T2 TJ	
			YSK 1030 T3 TJ	
			YSK 1030 T4 TJ	
			YSK 1030 T5 TJ	
			YSK 1030 T5 TJ	



Dimensions

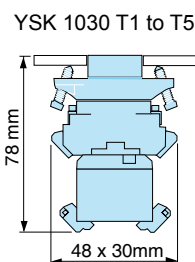
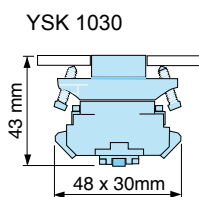
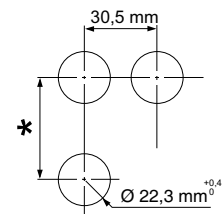
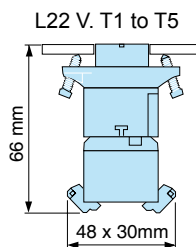
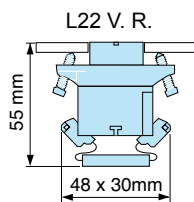
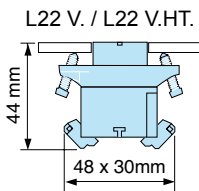

* Connection
by screws = 60 mm
by tabs = 90 mm

Standard indicator lights



Subassemblies - Bodies for indicator lights with Ba9S lamps (square heads and re-legendable heads)

- Lamp not supplied (except for versions with resistor or transformer) - Pwr = 3W max.
- Attachment by punch screws - Connection: screw / clamp plate IP2x (except for resistor versions)

Description	Power supply	Voltage	Part number	Weight kg
Body for indicator light with square head or re-legendable head	Direct Lamp not supplied	6 to 400V AC / DC (depending on lamp selected)	L22 KV BA9S TJ	0.075
	Resistor			
	230 / 130V 230 / 48V 130 / 48V	230V 230V 130V	L22 KV RE1 TJ L22 KV RE2 TJ L22 KV RE3 TJ	0.077
Other connection :				
F2 = Double tabs for 6.35 mm clip				
Example : L22 KV RE3 F2 TJ				
Transformer				
130 / 6V 230 / 6V 400 / 6V 130 / 24V 230 / 24V	130V/50 Hz- 110-120V/60 Hz 230V/50 Hz 400V/50 Hz 130V/50 Hz- 110-120V/60 Hz 230V/50 Hz	L22 KV T1 TJ L22 KV T2 TJ L22 KV T3 TJ L22 KV T4 TJ L22 KV T5 TJ	0.133	



Dimensions

Panel cutouts

L22 KV.

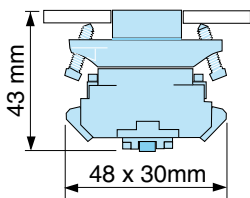

L22 KV R.

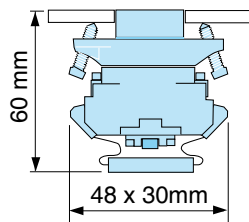

L22 KV T.

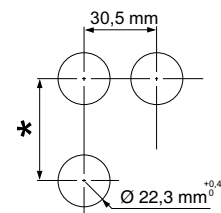
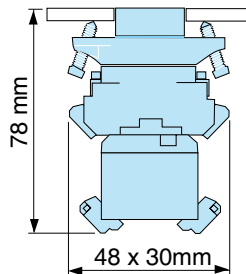

* Connection
by screws = 60 mm
by tabs = 90 mm

L22 KV.
(for re-legendable lights)

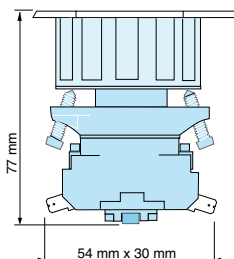

Standard indicator lights



Subassemblies - Bodies for LED lights - Ø 30 mm Range

- Attachment by punch screws
- Connection : screw / clamp plate IP2x

Description	Colour	Part number	Weight kg
Body for flush LED indicator light	●	LRDR2 .. V2 2F TJ	0.134
	●	LRDR3 .. V2 2F TJ	
	●	LRDR4 .. V2 2F TJ	
	●	LRDR5 .. V2 2F TJ	
	●	LRDR6 .. V2 2F TJ	
	○	LRDR9 .. V2 2F TJ	



Voltage : Complete the P/N

24V	AC / DC	24
48V	AC / DC	25
72V	AC / DC	26
(with tapping for earthing) 110V	AC / DC	27

VOLTAGE CODE

Other connection :

F2 = Double tabs for 6.35 mm clip

Example : LRDR924 **F2** 2F TJ

Dimensions

Panel cutouts

Ring MAL924B1 + washer EDU750A1 must be added when mounting control components from the 30 mm range

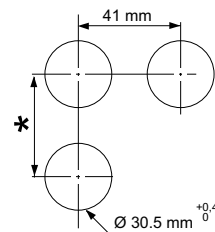
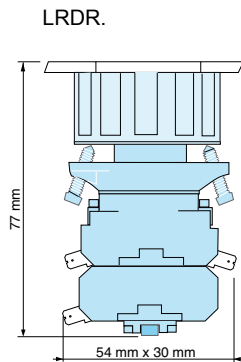

* Connection
by screws = 60 mm
by tabs = 90 mm

Standard indicator lights - Accessories - LED lamp



Compliance with standards







Certifications	IEC and NF 60947-5-1 and EN 50155
Vibration and shock resistance	IEC and NF EN 61373

Mechanical characteristics

Base	Ba9s
Height	28 mm
Operating temperature	-40°C / +85°C
Storage temperature	-40°C / +85°C

Electrical characteristics

Voltage	12V, 24V, 36V, 52V, 72V, 110V (+25%/-30%)
Consumption	~10mA
Overvoltage	1.4Unom/1s - 1.6Unom/100ms per EN 50121-2-3 and CEI 60061-1
Shock waves	1.8kV 1.2/50µs per EN 50121-2-3 and CEI 60061-1

Nominal voltage	Nominal current	Lighting threshold	Nominal luminous intensity +/- 25%	Ring color
12V	13mA	6.5V	1400mCd	
24V	13mA	14V	1200mCd	
36V	13mA	14V	1200mCd	
52V	9mA	28V	1000mCd	
72V	9mA	28V	800mCd	
110V	7mA	28V	600mCd	

Lighting characteristics

Color	warm white (2000°K to 4000°K)
High luminosity	from 600 to 1400 mCd depending voltage

LED lamp

EMC reinforced - Protection against : overvoltage, transient voltage, shock waves - Control of electric ignition threshold - High luminosity - Non-polarized - Ba9S socket - High mechanical resistance (resining) - Indication of the voltage according to the color of the plastic ring.

Description	Color	Voltage(ring color)	Part Number	Weight Kg
LED BA9S	○	12V (blue)	YSP1352BD23R9C1	0.002
		24V (yellow)	YSP1352BD24R9C1	
		36V (violet)	YSP1352BD25R9C1	
		52V (black)	YSP1352BD20R9C1	
		72V (green)	YSP1352BD26R9C1	
		110V (red)	YSP1352BD27R9C1	



Standard indicator lights - Accessories



Accessories for indicator lights - Ø 22 Range

Description	Part number	Weight Kg
Flexible gasket for IP54	JE	0.001
Gasket with metal insert for IP55 to IP66 or for thin front panels (1 to 4mm thick) liable for distortion	TJ	0.006
IP66 rubber sheath protecting against corrosive agents	DPE	0.070



Accessories for indicator lights - Ø 30 Range

Tightening ring and metal washer	MAL924B1 + EDU750A1	0.015
Flexible gasket for sealing Ø 30 heads	JDK118A1	0.001
Adapter from Ø 30.5 mm to Ø 22.5 mm	Chromium Black RE REN	0.008



Mounting and Dimensions

DPE

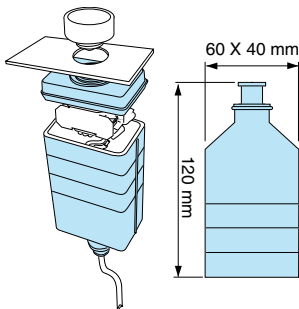

RE
REN

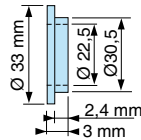

Mounting for indicator lights - Ø 22 and 30 Range

Round Ø 22 range

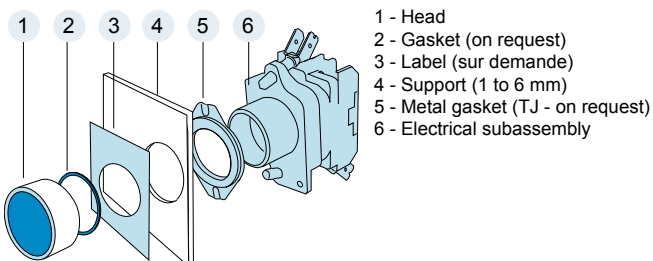

Ø 30 range

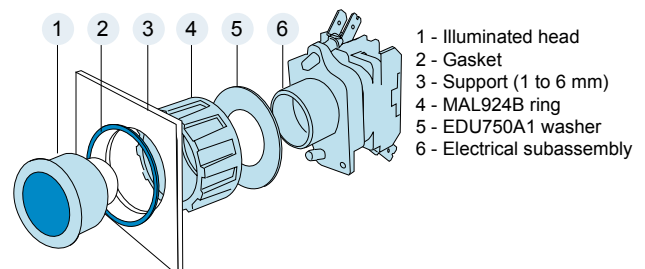

Square Ø 22 range

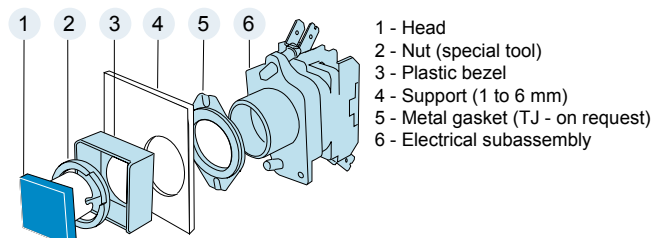

Spécial indicator lights



Adaptability
Modularity
Safety
Reliability



Satisfaction guaranteed : custom-build indicator lights.

MAFELEC's indicator lights can be designed to cover all applications :

Stationary or on-board.
Railway, industry, lifts,
défense ect ..., they comply
with the standards in force
in each of these fields of
activity.



Special indicator lights



LED lights, O.D. 36 mm

- 7 LEDs, Ø 5 mm - Black plastic body.
- Connection : 6.35 x 0.8 Faston tabs per NFF 00 364 on "O" halogen cable, per NFF 63 808 - Attachment : M 32 x 1.5 threads
- Protective cover withstands detergents - Degree of protection IP65 for front panel (NFC 20010)

Description	Voltage	Colour	Part number	Weight kg
	72V AC/ DC		YSP 1138 R2 26 YSP 1138 R3 26 YSP 1138 R5 26 YSP 1138 R6 26	0.023



LED lights, O.D. 40 mm - Cutout Ø: 36 mm

- 18 LEDs, Ø 5 mm . Reverse polarity protection diode.
- Black metal bezel - cannot be removed - Black metal body.
- Connection : Single tab for 6.35 mm clip - Attachment with metal nut and 2 punch screws.
- Degree of protection IP65

Description	Voltage	Colour	Part number	Weight kg
	24V DC	● ● ● ● ●	P36 LA R5 E 04 F1 5C P36 LA R2 E 04 F1 5C P36 LA R4 E 04 F1 5C P36 LA R3 E 04 F1 5C P36 LA R6 E 04 F1 5C	0.140
	48V DC	● ● ● ● ●	P36 LA R5 E 05 F1 5C P36 LA R2 E 05 F1 5C P36 LA R4 E 05 F1 5C P36 LA R3 E 05 F1 5C P36 LA R6 E 05 F1 5C	
	72V DC	● ● ● ● ●	P36 LA R5 E 06 F1 5C P36 LA R2 E 06 F1 5C P36 LA R4 E 06 F1 5C P36 LA R3 E 06 F1 5C P36 LA R6 E 06 F1 5C	
	110V DC	● ● ● ● ●	P36 LA R5 E 07 F1 5C P36 LA R2 E 07 F1 5C P36 LA R4 E 07 F1 5C P36 LA R3 E 07 F1 5C P36 LA R6 E 07 F1 5C	



Connection via screws/clamp plate IP2X or long version for front panel from 1 to 37 mm in depth: Contact us.

Dimensions

Cutouts

YSP 1138.

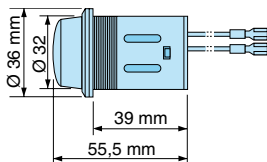

P36 LA.

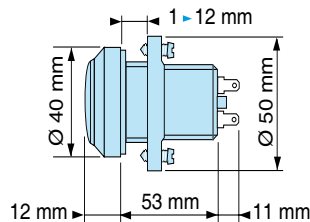

Panel cutouts

(from 1 to 12 mm in depth)

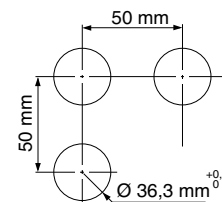

Special indicator lights



LED lights, O.D. 45 mm - Cutout Ø: 39 mm

- 2 x 6 LEDs - Reverse polarity protection diode - Current consumption 40 mA max.
- Body and bezel in bright anodised aluminium - Attachment by metal nut and 2 punch screws.
- Connection : AMP connector on teflon cable.
- Degree of protection IP65 for the front panel

Description	Voltage	Colour	Part number	Weight kg
	37.5V DC (24 to 44V)	Amber (standard)	YSP 1154	0.120

Other possible colours - White, Blue, Green, Red
Contact us.



LED lights, O.D. 57 mm - Cutout Ø: 50 mm

- 2 x 6 LEDs - Reverse polarity protection diode - Current consumption 40 mA max.
- Body and bezel in bright anodised aluminium - Attachment by metal nut and 2 punch screws.
- Connection : AMP connector on teflon cable.
- Degree of protection IP65 for the front panel

Description	Voltage	Colour	Part number	Weight kg
	37.5V DC (24 to 44V)	Amber (standard)	YSP 1080	0.195

Other possible colours - White, Blue, Green, Red
Contact us.



Dimensions

Cutouts

YSP 1154

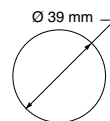
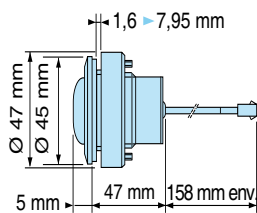

YSP 1080

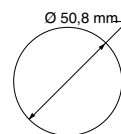
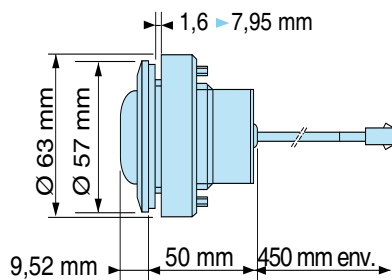

Special indicator lights



LED lights, O.D. 82 mm - Cutout Ø : 56 mm

- Amber : 3 x 10 LEDs, Ø 5 mm - White : 6 x 5 LEDs, Ø 3 mm.
- Brightness control system - Power consumption : 100mA max. - Connection : Screw terminal block.
- Smooth or lens-type protective cover - Degree of protection : IP 66 for the front panel.
- Metal body - Metal tightening ring and punch screws.

Description	Voltage	Colour	Part number	Weight kg
Round LED light. Large size. Brightness control.	24V AC	● ○	YSP 1171 YSP 1173	0.20

Other colours or operating voltages:
Contact us



- 2 x 12 LEDs, Ø 5 mm
- Power consumption: 30mA nominal - Connection : Double 6.35 x 0.8 mm Faston tabs.
- Smooth or lens-type protective cover - Degree of protection : IP 66 for the front panel.
- Metal body - Metal tightening ring and punch screws.

Description	Voltage	Colour	Part number	Weight kg
Round LED light. Large size.	72V DC	●	YSP 1128	0.20

Other colours or voltages:
Contact us



- Amber : 2 x 15 LEDs, Ø 3 mm.
- Brightness control system - Power consumption : 100mA max. - Connection : Screw terminal block.
- Smooth or lens-type protective cover - Degree of protection : IP 66 for the front panel.
- Metal body - Metal tightening ring and punch screws.

Description	Voltage	Colour	Part number	Weight kg
Round LED light. Large size. Side lighting.	24V AC	●	YSP 1172	0.20

Other colours or operating voltages:
Contact us



Dimensions

Cutouts

YSP 1171 / 72 / 73

YSP 1128

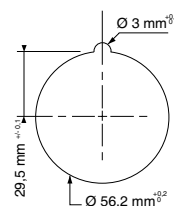
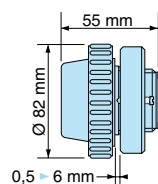
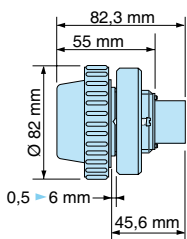

Special indicator lights



Lamp indicator lights, O.D. 82 mm - Cutout Ø: 40 mm max.

- 2 festoon lamps provided - Railway approvals (vibration resistance) - Mounted on PCB complying with EZ 5004.
- Interchangeability : From the front without removing the light.
- Protective cover fastening : By chrome-plate metal nut.
- Visible from de side and front.
- Connection : By tab for 6.35 clip.
- Degree of protection : IP66

Description	Voltage	Colour	Part number	Weight kg
Round light with festoon lamps.	12V DC	●	YSP 1083 R5 03 F1 1	0.130
		●	YSP 1083 R2 03 F1 1	
		●	YSP 1083 R4 03 F1 1	
		●	YSP 1083 R3 03 F1 1	
		●	YSP 1083 R6 03 F1 1	
		⊗	YSP 1083 R8 03 F1 1	
		○	YSP 1083 R9 03 F1 1	
	24V DC	●	YSP 1083 R5 04 F1 1	
		●	YSP 1083 R2 04 F1 1	
		●	YSP 1083 R4 04 F1 1	
		●	YSP 1083 R3 04 F1 1	
		●	YSP 1083 R6 04 F1 1	
		⊗	YSP 1083 R8 04 F1 1	
		○	YSP 1083 R9 04 F1 1	
	48V DC	●	YSP 1083 R5 05 F1 1	
		●	YSP 1083 R2 05 F1 1	
		●	YSP 1083 R4 05 F1 1	
		●	YSP 1083 R3 05 F1 1	
		●	YSP 1083 R6 05 F1 1	
		⊗	YSP 1083 R8 05 F1 1	
○		YSP 1083 R9 05 F1 1		
72V DC	●	YSP 1083 R5 06 F1 1		
	●	YSP 1083 R2 06 F1 1		
	●	YSP 1083 R4 06 F1 1		
	●	YSP 1083 R3 06 F1 1		
	●	YSP 1083 R6 06 F1 1		
	⊗	YSP 1083 R8 06 F1 1		
	○	YSP 1083 R9 06 F1 1		



Other connection :

D1 = Double tabs for 5 mm clip

Example : YSP 1083 R9 06 **D1** 1

Other attachment :

3 = Black plastic nut

Example : YSP 1083 R9 06 F1 **3**

WARNING! Some Part Numbers are not held in regular stock (contact us)

Dimensions

Cutouts

YSP 1083

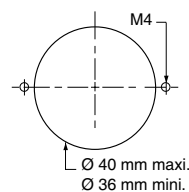
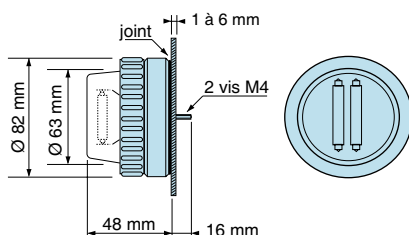

Special indicator lights



External signalling units

- Compliance with standards : NFF 62000 - NFA 91102 - NFE 25100 - NFE 25032
- Specially designed for maintainability.
- Assembly comprising :
 - 1 support frame : Cast aluminium, grey epoxy metallic paint 862 (French railway P/N) withstands detergents.
 - Sealing IP66 - NFC 20010 (with drainage for condensation).
 - 2 or 3 lights, Ø 80 fitted with two 45V - 8W festoon lamps Railway approvals (vibration resistance), mounted on a PBC complying with EZ 5004.
- Connection : connector for 6.35 clips.
- Interchangeability : From the front without removing the unit.
- Illumination visible from the front and sides.
- Colours : Blue, White, Yellow
- Supply voltage : 83V nominal (variation from 50 to 90V).
- Wiring : 0.93 mm² wires, "O" halogen NFF 63808.
- Attachment : 4 captive CHC M5 x 30 screws.

Description	Voltage	Colour	Part number	Weight kg
2-light signalling unit, round version.		1 st light: Crystal 2 nd light: Yellow	YSP 1072	0.670
3-light signalling unit, round version.		1 st light: Blue 2 nd light: Crystal 3 rd light: Yellow	YSP 1071	0.725



Other voltages, light colours or supports:
Contact us.

Dimensions

YSP 1071

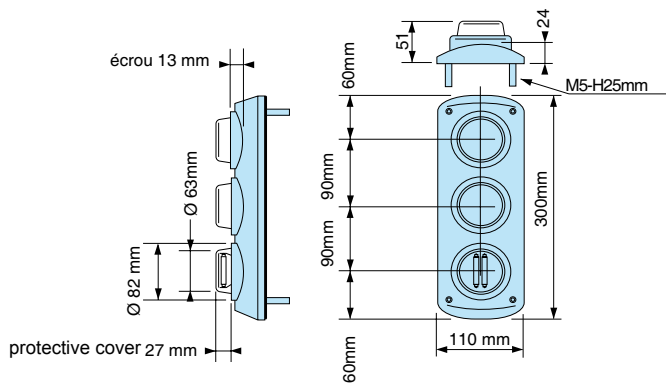

YSP 1072

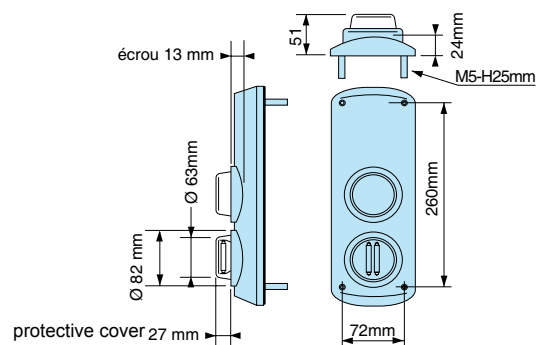

Special indicator lights



Flat LED lights

- 18 LEDs, Ø 5 mm - 2 circuits, each with 9 LEDs
- Protective cover (Ø 40 mm) cannot be disassembled (vandal-proof), mounted in a grey plastic casing.
- Reverse polarity protection diode.
- Connection : **+ terminal** : 1 single 5 x 0.8 tab. **- terminal** : 1 single 6.35 x 0.8 tab.
- Degree of protection : IP 65
- Attachment : By 2 M4 screws for oblong holes, 15 x 5 mm, on sheet metal.

Description	Voltage	Colour	Part number	Weight kg
Flat light	24V DC	●	YSP 1082 R5 04	0.145
		●	YSP 1082 R2 04	
		●	YSP 1082 R4 04	
	48V DC	●	YSP 1082 R5 05	
		●	YSP 1082 R2 05	
		●	YSP 1082 R4 05	
	72V DC	●	YSP 1082 R5 06	
		●	YSP 1082 R2 06	
		●	YSP 1082 R4 06	

Other version :
Light with flush protective cover, P/N: YSP 1093 . . .



- 19 LEDs, Ø 5 mm
- One-piece protective cover and housing (protective cover Ø 40 mm)
- Reverse polarity protection diode
- Connection : Deutsch Connector : DT04-2P
- Degree of protection : IP 65 (flat gasket)

Description	Voltage	Colour	Part number	Weight kg
Flat one-piece light	72V DC	●	YSP 1178 R5 06	0.05
		●	YSP 1178 R2 06	
		●	YSP 1178 R4 06	
	110V DC	●	YSP 1178 R5 07	
		●	YSP 1178 R2 07	
		●	YSP 1178 R4 07	



- 19 LEDs, Ø 5 mm
- One-piece protective cover and housing (Ø 40 mm protective cover)
- Reverse polarity protection diode
- Connection : Deutsch Connector : DT04-2P
- Degree of protection : IP 65 (flat gasket)

Description	Voltage	Colour	Part number	Weight kg
Flat one-piece light, flashing (3 Hz)	72V DC	●	YSP 1178 R5 06	0.05
		●	YSP 1178 R2 06	



Dimensions

YSP 1082
YSP 1093 (flush protective cover)

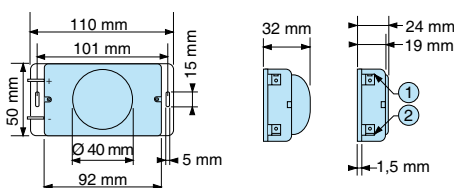

YSP 1178

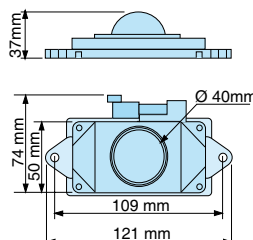

Special indicator lights



Beacon-style LED lights (3-way visibility)

- 31 LEDs, Ø 5 mm - 2 side circuits, each with 8 LEDs - 1 front circuit with 15 LEDs
- Protective cover with Fresnel lens on the front, smooth at the sides
- Reverse polarity protection diode
- Connection : Double 5 or 6.35 mm tabs.
- Degree of protection : IP 65 for the front panel.
- Attachment : Sliding attachment clamp. Fastening by 3 M3 screws.

Description	Voltage	Colour	Part number	Weight kg
LED light. Large size. 3-way visibility	24V DC	●	YSP 1264A . 24	0.10
		●	YSP 1264A . 26	
		●	YSP 1264A . 23	
		○	YSP 1264A . 29	
	72V DC	●	YSP 1264A . 44	
		●	YSP 1264A . 46	
		○	YSP 1264A . 49	
	110V DC	●	YSP 1264A . 64	
		●	YSP 1264A . 66	
		○	YSP 1264A . 69	

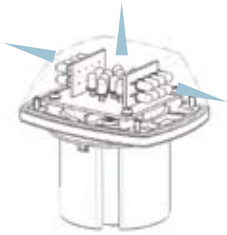

1 = Double tabs for 5 mm clip
2 = Double tabs for 6.35 mm clip

LED Tail light

- 30 LEDs, Ø 5 mm - 2 circuits, each with 15 LEDs
- Protective cover with Fresnel lens on the front, smooth at the sides
- Reverse polarity protection diode
- Connection : Double 6.35 mm tabs.
- Degree of protection : IP 65 for the front panel.
- Attachment : Sliding attachment clamp. Fastening by 3 M3 screws.

Description	Voltage	Colour	Part number	Weight kg
Tail light	48V AC		YSP 1198AI15R4F2	0.10
			YSP 1198AI15R5F2	
	110V DC		YSP 1198AF07R2F2	



Dimensions

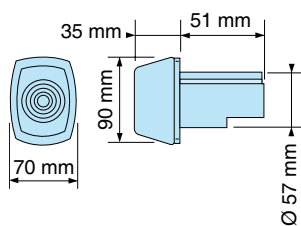

Cutouts

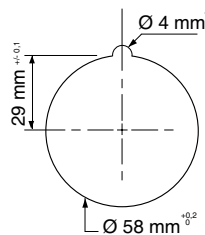

Consult our other catalogues



471 Route de la Cuisinière
38 490 CHIMILIN-FRANCE
Tél. : 04 76 32 07 33
Fax. : 04 76 32 54 11
Mail : contact@mafelec.fr
www.mafelec.com