

# connection solutions in stainless steel

## flow control regulators



### 7810 with threaded fitting, BSP parallel and metric



C	exhaust (A)	E	E1	F	H	J	L
M5x0,8	<b>7810 19 19</b>	4	4	8	24	10	11
G1/8	<b>7810 10 10</b>	5	8	13	38	15	17
G1/4	<b>7810 13 13</b>	8	12	17	40	18	24
G3/8	<b>7810 17 17</b>	7	12	20	53	22	24
G1/2	<b>7810 21 21</b>	8	15	23	69	28	31

= suitable for food applications

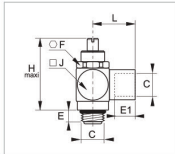

### 7812 with threaded fitting, BSP parallel and metric



C	bi-directional (C)	E	E1	F	H	J	L
M5x0,8	<b>7812 19 19</b>	4	4	8	24	10	11
G1/8	<b>7812 10 10</b>	5	8	13	38	15	17
G1/4	<b>7812 13 13</b>	8	12	17	40	18	24
G3/8	<b>7812 17 17</b>	7	12	20	53	22	24
G1/2	<b>7812 21 21</b>	8	15	23	69	28	31

= suitable for food applications

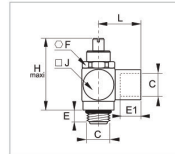

### 7810-7815 with threaded fitting, UN/UNF and NPT



C	exhaust (A)	E	E1	F	H	J	L
10-32	<b>7810 20 20</b>	4	4	8	24	10	11
1/8	<b>7815 11 11</b>	5	8	13	38	15	17
1/4	<b>7815 14 14</b>	8	12	17	40	18	24
3/8	<b>7815 18 18</b>	7	12	20	53	22	24
1/2	<b>7815 22 22</b>	8	15	23	69	28	31

= suitable for food applications

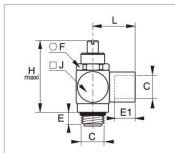

### 7812-7817 with threaded fitting, UN/UNF and NPT



C	bi-directional (C)	E	E1	F	H	J	L
10-32	<b>7812 20 20</b>	4	4	8	24	10	11
1/8	<b>7817 11 11</b>	5	8	13	38	15	17
1/4	<b>7817 14 14</b>	8	12	17	40	18	24
3/8	<b>7817 18 18</b>	7	12	20	53	22	24
1/2	<b>7817 22 22</b>	8	15	23	69	28	31

= suitable for food applications

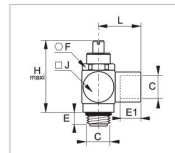

### 12 7820 in-line, one-way, BSP parallel



C	DN	exhaust (A)	H <sub>maxi</sub>	H1	L	L1	L2	N	ØT
G1/8	7	<b>7820 00 10</b>	67	30	40	30	20	20	20
G1/4	7	<b>7820 00 13</b>	67	30	40	30	20	20	20
G3/8	9	<b>7820 00 17</b>	76	35	50	36	25	25	25
G1/2	12	<b>7820 00 21</b>	87	40	60	42	30	30	30

Working temperature: -15° to + 120°C  
PN= 16 bar  
NPT threads: please consult us

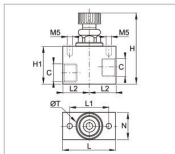

### 7822 in-line, bi-directional, BSP parallel



C	DN	bi-directional (C)	H <sub>maxi</sub>	H1	L	L1	L2	N	ØT
G1/8	7	<b>7822 00 10</b>	67	30	40	30	20	20	20
G1/4	7	<b>7822 00 13</b>	67	30	40	30	20	20	20
G3/8	9	<b>7822 00 17</b>	76	35	50	36	25	25	25
G1/2	12	<b>7822 00 21</b>	87	40	60	42	30	30	30

Working temperature: -15° to + 120°C  
PN= 40 bar  
NPT threads: please consult us

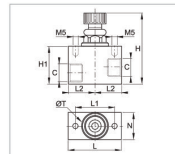

### Technical specifications of flow control regulators

Working pressure: 1 to 10 bar  
Working temperature: 0°C to + 70°C

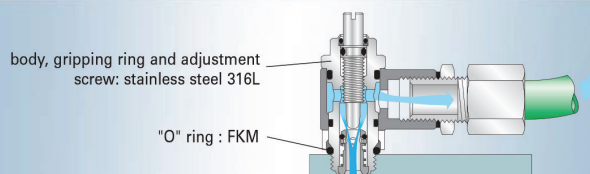

# connection solutions in stainless steel

## non-return valves

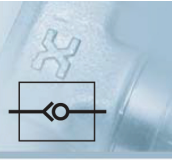

### 4890 female-female, BSP parallel



C	DN		ØD	F	L
G1/8	10	4890 10 10	22	17	50
G1/4	10	4890 13 13	22	17	50
G3/8	15	4890 17 17	30	22	67
G1/2	15	4890 21 21	30	25	71
G3/4	20	4890 27 27	42	32	84
G1"	25	4890 34 34	42	38	90

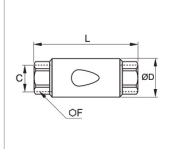

### 4891 male-female, BSP parallel



C	DN		ØD	F	L
G1/8	10	4891 10 10	22	17	56
G1/4	10	4891 13 13	22	17	58
G3/8	15	4891 17 17	30	22	75
G1/2	15	4891 21 21	30	25	79
G3/4	20	4891 27 27	42	32	98
G1"	25	4891 34 34	42	38	104

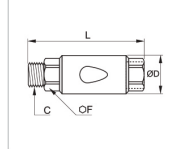

### 4892 female-male, BSP parallel



C	DN		ØD	F	L
G1/8	10	4892 10 10	22	17	56
G1/4	10	4892 13 13	22	17	58
G3/8	15	4892 17 17	30	22	75
G1/2	15	4892 21 21	30	25	79
G3/4	20	4892 27 27	42	32	98
G1"	25	4892 34 34	42	38	104

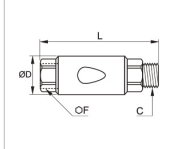

### 4895 female-female, NPT



C	DN		ØD	F	L
1/8	10	4895 11 11	22	18	50
1/4	10	4895 14 14	22	18	54
3/8	15	4895 18 18	30	22	73
1/2	15	4895 22 22	30	25	77

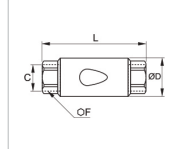

13

## quick vent valves

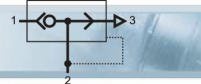

### 7899 double female, BSP parallel



C	DN		F	F1	H	L	L1	L2
G1/8	7	7899 00 10	17	22	33	37,5	21	16,5
G1/4	7	7899 00 13	17	22	33	37,5	21	16,5
G3/8	9	7899 00 17	22	26	37	44,5	25,5	19
G1/2	12	7899 00 21	27	32	46	54	31	23
G3/4	18	7899 00 27	38	46	65	79	44	35
G1"	18	7899 00 34	38	46	65	79	44	35

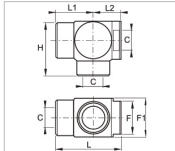

Body stainless steel 316L

● models G1/8 and G1/4:

FKM seals, working temperature: -10° to +120°C

● models G3/8 to G1":

nylon valve, working temperature: -20° to +80°C

Also available, male-female, NPT threads: please consult us.

## Technical specifications of non-return valves

Working pressure: 0,5 to 40 bar

Working temperature: -20° to +180°C

