

17/4F ISO 6162-1-Flange 45° Elbow

ISO 12151-3 – E45S – L – SFL 45°
(35.0 MPa/ 5000 psi)

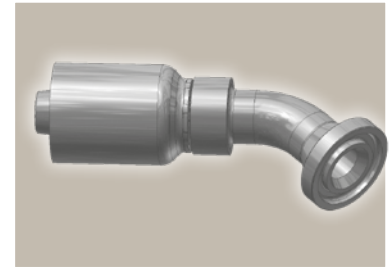
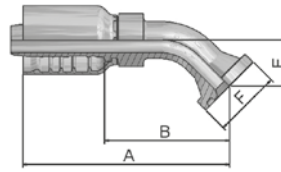

| Part Number | Hose I.D. | | | | Flange Inch | A mm | B mm | E mm | F mm |
|-------------|-----------|-------|------|------|----------------|---------|---------|---------|---------|
| | DN | Inch | Size | mm | | | | | |
| 11777-8-8 | 12 | 1/2 | -8 | 12.7 | 1/2 | 79 | 45 | 20 | 30 |
| 11777-12-8 | 12 | 1/2 | -8 | 12.7 | 3/4 | 81 | 47 | 22 | 38 |
| 11777-10-10 | 16 | 5/8 | -10 | 15.9 | 5/8 | 103 | 64 | 24 | 34 |
| 11777-12-12 | 19 | 3/4 | -12 | 19.1 | 3/4 | 116 | 70 | 26 | 38 |
| 11777-16-12 | 19 | 3/4 | -12 | 19.1 | 1 | 116 | 70 | 26 | 45 |
| 11777-16-16 | 25 | 1 | -16 | 25.4 | 1 | 130 | 76 | 32 | 45 |
| 14F77-20-16 | 25 | 1 | -16 | 25.4 | 1 1/4 | 130 | 76 | 32 | 51 |
| 14F77-20-20 | 31 | 1 1/4 | -20 | 31.8 | 1 1/4 | 167 | 104 | 38 | 51 |
| 14F77-24-20 | 31 | 1 1/4 | -20 | 31.8 | 1 1/2 | 167 | 104 | 38 | 60 |
| 14F77-24-24 | 38 | 1 1/2 | -24 | 38.1 | 1 1/2 | 192 | 125 | 44 | 60 |
| 14F77-32-24 | 38 | 1 1/2 | -24 | 38.1 | 2 | 192 | 125 | 44 | 71 |
| 14F77-32-32 | 51 | 2 | -32 | 50.8 | 2 | 211 | 134 | 56 | 71 |

SAE flange halves see in section Eb.

Fittings with standard O-ring seals can be used for temperatures from -40 °C up to +105 °C.
O-rings see section Eb. Special O-rings are available on request.

Approved **fitting series** for **hose types**, depending on size:

| | | | | | | | | | | | | | | |
|-----------|--------|--------|-------|-----|-------|-------|-----|-------|-------|-----|-------|-------|-------|----------|
| 77 | 387 | 387ST | 387TC | 487 | 487ST | 487TC | 787 | 787TC | 787ST | 797 | 797TC | 797ST | 797RH | SX42 ... |
| | SX42LT | SX42TC | | | | | | | | | | | | |